



Wings Road Close, Lakenheath, Suffolk, IP27 9HY

Rent - Guide Price £395,000 Deposit -

This modern detached family home situated in the popular village of Lakenheath. The property benefits from a spacious kitchen / diner, large lounge, 4 bedrooms & 2.5 bathrooms. There is off road parking & an enclosed rear garden.

- DETACHED FAMILY HOME
- 4 BEDROOMS
- LIVING ROOM
- FAMILY BATHROOM, ENSUITE & CLOAKROOM
- PARKING & ENCLOSED REAR GARDEN
- MODERN FULLY FITTED KITCHEN
- GAS HEATING & ENERGY RATING - C
- APPROXIMATE SIZE - 1316 SQ FT
- COUNCIL TAX BAND - D
- CHAIN FREE



Council Tax Band: D - EPC Rating: C 69

GROUND FLOOR
792 sq.ft. (73.5 sq.m.) approx.



1ST FLOOR
525 sq.ft. (48.8 sq.m.) approx.

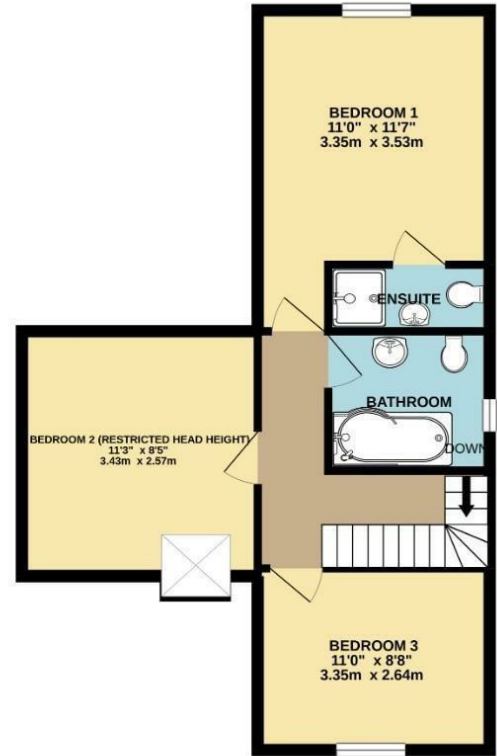

TOTAL FLOOR AREA: 1316 sq.ft. (122.3 sq.m.) approx.

Whilst every attempt has been made to ensure the accuracy of the floorplan contained here, measurements of doors, windows, rooms and any other items are approximate and no responsibility is taken for any error, omission or mis-statement. This plan is for illustrative purposes only and should be used as such by any prospective purchaser. The services, systems and appliances shown have not been tested and no guarantee as to their operability or efficiency can be given.
Made with Metropix ©2020

