



Falcon
lettings

01752 600828

255C Beacon Park Road

Plymouth, Plymouth, PL2 2SH

Monthly Rental Of £950



In Brief

Spacious two bedroom first floor apartment

Newly redecorated and new carpets throughout

Excellent location for the City centre and routes to Derriford/North of the City

Gas central Heating and uPVC double glazing

Parking Allocated for 1 car

EPC C80

Council Tax Band A - the least expensive

Rent £950pcm - Deposit £1,096 - Hold Deposit £219

Let and Managed by Falcon

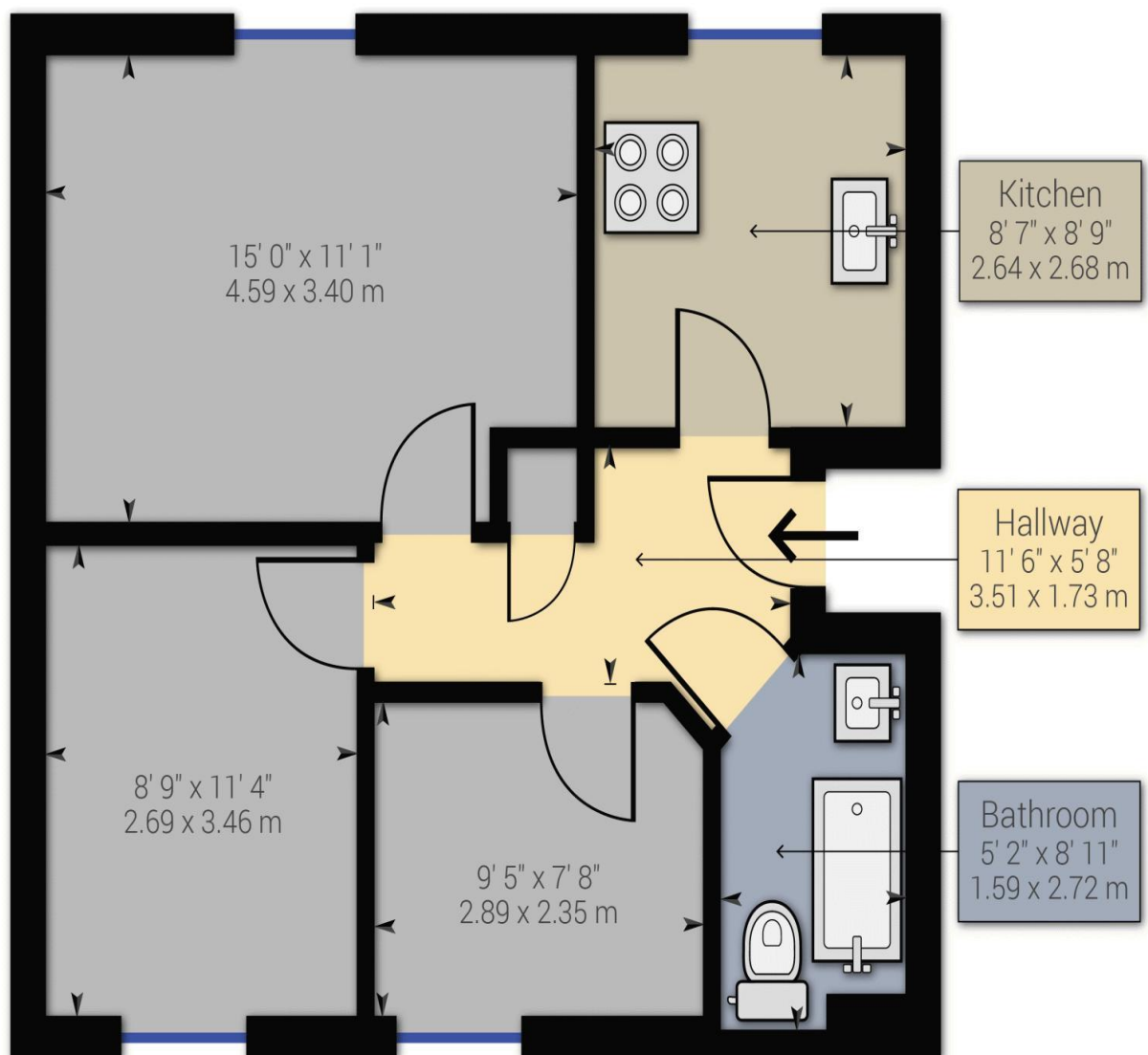

Approximate net internal area: 524.85 ft² / 48.76 m²

While every attempt has been made to ensure accuracy, all measurements are approximate, not to scale. This floor plan is for illustrative purpose only and should be used as such by any

www.falconlettings.com

8 Mannamead Road Mutley Plymouth PL4 7AA

Email: lettings@falconproperty.com

