



Enfields Eastleigh
1E Leigh Road,
Eastleigh, Southampton,
Hampshire, SO50 9FG
T 023 8061 3646
E sales-eastleigh@enfields.co.uk

Chiltern Crescent, Fair Oak, SO50

Part Buy Part Rent £130,000

🛏️ 2 🍽️ 1 🚿 1



A Very well presented two double bedroom terraced home available for sale with no forward chain and offering spacious living accommodation throughout, including kitchen/breakfast room, living/ dining room and a large W/C to the ground floor.

Upstairs there are two generous sized double bedrooms and modern bathroom. This home is approximately 5 years old and available through the shared ownership scheme at 40% (£130,000) of the full value (£325,000).

If you buy a 40% share, the share purchase price will be £130,000 and the rent will be £436.97 a month. The remaining lease on the shared ownership purchase is 120 years.

Please get in touch for further information or to arrange a viewing.



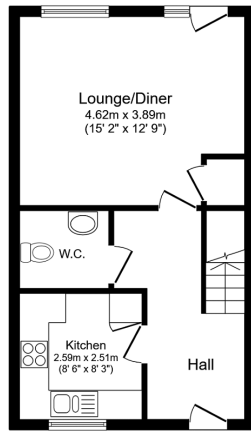

Ground Floor
Floor area 38.3 m² (412 sq.ft.)

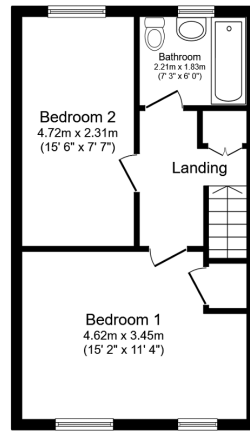

First Floor
Floor area 38.3 m² (412 sq.ft.)

TOTAL: 76.5 m² (824 sq.ft.)

This floor plan is for illustrative purposes only. It is not drawn to scale. Any measurements, floor areas (including any total floor area), openings and orientations are approximate. No details are guaranteed, they cannot be relied upon for any purpose and do not form any part of any agreement. No liability is taken for any error, omission or misstatement. A party must rely upon its own inspection(s). Powered by www.Propertybox.co

- 40% Share At £130,000
- Two Double Bedrooms
- Lounge/Dining Room
- No Forward Chain
- Private Rear Garden
- 100% Ownership At £325,000
- Two Allocated Parking Spaces
- Modern Development
- Popular Location
- Early Viewing Highly Recommended

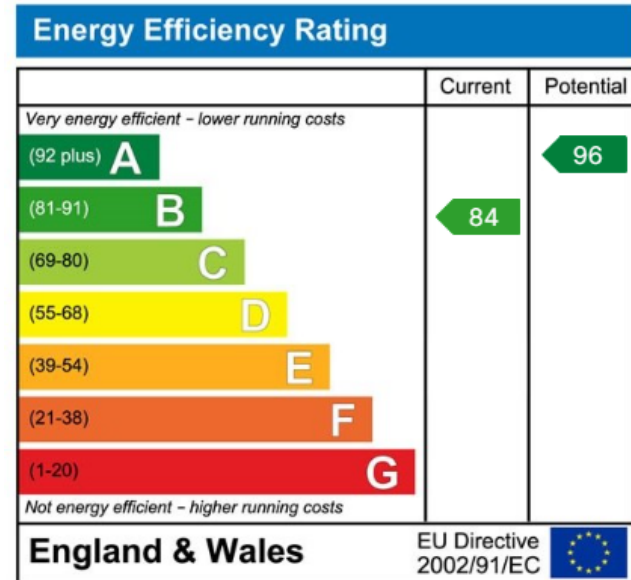

www.enfields-southampton.co.uk



It is Enfields policy to respect any sole agency currently in force and we would not be able to commence marketing until this has expired or been terminated. If you fail to terminate any previous agreement you could be liable for two sets of fees. Enfields Eastleigh is a trading name of YTF LTD Registered office: 345 Shirley Road, Southampton, Hampshire, England, SO15 3JD. Company Registration No: 10459987. VAT Registration No: 281 2975 81.

Enfields Lettings - Embley Management LTD T/A Enfields. Registered Address: 345 Shirley Road, Southampton, Hampshire, England, SO15 3JD. Company Registration No: 14847604. VAT Registration No: 439 8546 45.

