



Enfields Hythe
3 Marsh Parade,
Hythe, Southampton,
Hampshire, SO45 6AN
T 023 8084 9210
E sales-hythe@enfields.co.uk

Bartram Road, Totton, SO40

Guide Price £300,000-£325,000

3 1 2



- No Forward Chain
- Two Reception Rooms
- Summer House With Internet
- Well Presented Throughout
- Modern Bathroom
- Three bedrooms
- Detached House
- Log Burner In Living Room
- Air Conditioning
- Low Maintenance Rear Garden



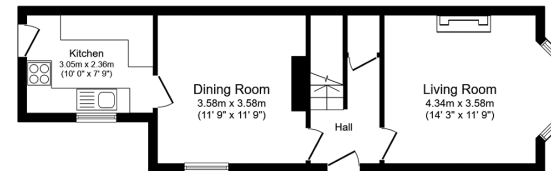

Ground Floor

Floor area 41.1 sq.m. (443 sq.ft.)

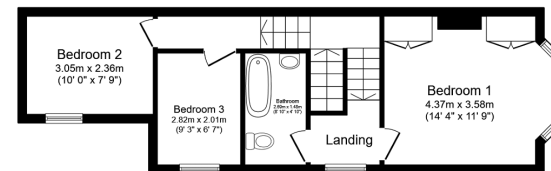

First Floor

Floor area 41.1 sq.m. (443 sq.ft.)

TOTAL: 82.3 sq.m. (885 sq.ft.)

This floor plan is for illustrative purposes only. It is not drawn to scale. Any measurements, floor areas (including any total floor area), openings and orientations are approximate. No details are guaranteed, they cannot be relied upon for any purpose and do not form any part of any agreement. No liability is taken for any error, omission or misstatement. A party must rely upon its own inspection(s). Powered by www.Property24.co

GUIDE PRICE £300,000 -£325,000

A three bedroom, two reception room family home presented to a very high standard by the current owners and available for sale with no forward chain.

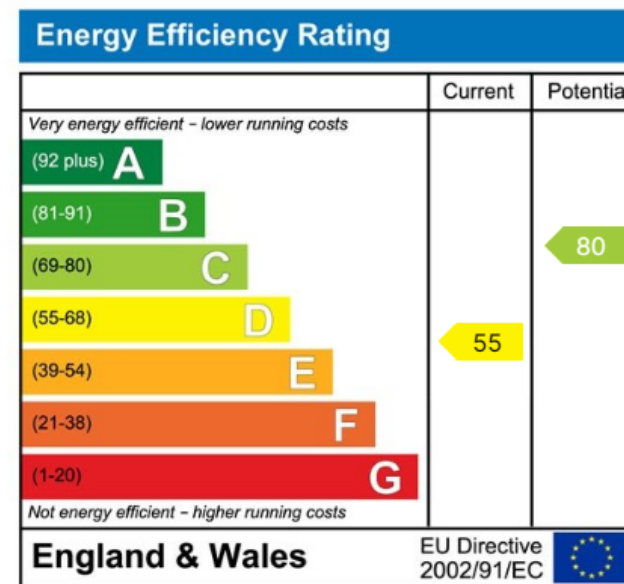

www.enfields-southampton.co.uk



It is Enfields policy to respect any sole agency currently in force and we would not be able to commence marketing until this has expired or been terminated. If you fail to terminate any previous agreement you could be liable for two sets of fees. Enfields Hythe is a trading name of YTF LTD Registered office: 345 Shirley Road, Southampton, Hampshire, England, SO15 3JD. Company Registration No: 10459987. VAT Registration No: 281 2975 81.

Enfields Lettings - Embley Management LTD T/A Enfields. Registered Address: 345 Shirley Road, Southampton, Hampshire, England, SO15 3JD. Company Registration No: 14847604. VAT Registration No: 439 8546 45.

