



# Park West Building, Bow Quarter

Guide Price £325,000 Leasehold

OLIVER  JAUQUES  
EST. 1986



## Park West Building, Bow Quarter

**\*\*GUIDE PRICE £325,000 - £350,000 \*\***

This 1-bedroom, first floor, dual aspect apartment is situated in the popular and private Bow Quarter development which provides residents with a range of amenities and serene surroundings. The apartment boasts a modernised kitchen which opens up onto a bright and spacious living / dining room as well as a contemporary bathroom and cosy bedroom. As a resident of the development, you have access to a well-equipped leisure facility with 15m heated pool, jacuzzi, sauna, steam room and gym. Furthermore, there are three communal green spaces as well as a sun terrace with a WIFI connection to enjoy.

The development is well positioned for public transport including the DLR from Bow Church, Circle, Hammersmith and city lines from Bow Road and Central and district lines from Mile End Station. There are also various bus routes immediately outside the development.

- Dual Aspect
- Modernised Kitchen and Bathroom
- Fantastic Leisure Facilities
- Allocated Parking Space
- 24h Concierge & Security
- Manicured Communal Gardens

Oliver Jaques Bow Sales  
020 8980 0999

Email [southeast@o-j.co.uk](mailto:southeast@o-j.co.uk)

Unit A Arlington Building, London, E3 2UB

web <https://www.o-j.co.uk/>

Every care has been taken with the preparation of this brochure but it is for general guidance only and complete accuracy cannot be guaranteed. If there is any point, which is of importance professional verification should be sought. This brochure does not constitute a contact or part of a contract. We are not qualified to verify tenure of property. Prospective purchasers should seek clarification from their solicitor or verify the tenure of this property for themselves by visiting [www.gov.uk/government/organisations/land-registry](http://www.gov.uk/government/organisations/land-registry). The mention of any appliances, fixtures or fittings does not imply they are in full working order. Photographs are reproduced for general information and it cannot be inferred that any item shown is included in the sale. All dimensions are approximate. Walking times are taken from Google Maps and measured from the centre of the postcode, which may differ from the individual property. We routinely refer clients to Chancery Mortgage Services Ltd. It is your decision whether you choose to deal with Chancery Mortgage Services Ltd. In making that decision, you should know that we receive an annual payment benefits from Chancery Mortgage Services Ltd, equating to approximately £220 per referral

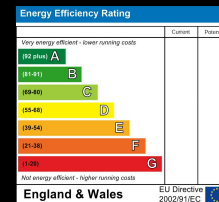

**Fairfield Road, London, E3**

Approximate Area = 423 sq ft / 39.3 sq m

For identification only - Not to scale

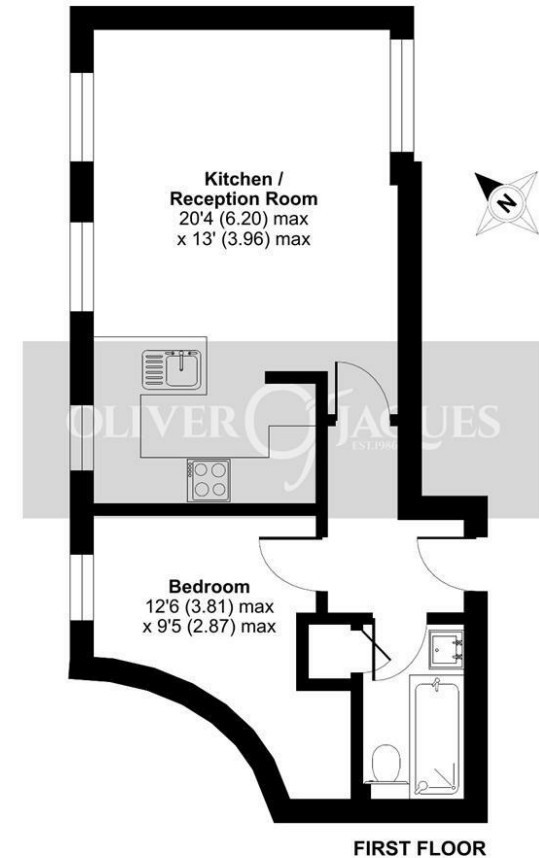

Floor plan produced in accordance with RICS Property Measurement Standards incorporating International Property Measurement Standards (IPMS2 Residential). © rnichecom 2023. Produced for Oliver Jaques. REF: 1109029

**Tenure:** Leasehold

**Ground Rent:** £125 p/a

**Service Charge:** £3,502 p/a

**Lease Expires:** 2113

**Shared Ownership:** No

**Council Tax Band:** Tower Hamlets (Band D)

£1,675.51