



Manhattan Building, Bow Quarter, E3

Guide Price £317,500 Leasehold

OLIVER  JAUQUES
EST.1986



Manhattan Building, Bow Quarter, E3

A naturally bright, south-facing one bedroom mezzanine apartment situated on the third floor of the converted Bryant and May match factory grade 2 listed building. A distinguishing trait of a Manhattan Building apartment in the Bow Quarter is the large, original window that floods natural light into the open plan living / dining / kitchen area. The apartment boasts a fitted kitchen, extremely high ceilings and mezzanine bedroom with walk-in wardrobe.

The Bow Quarter, a private, gated development offers a range of amenities to its residents including 24 hour concierge and security, large communal roof terrace, on-site postal office, on-site convenience store, leisure facilities including 15 meter swimming pool, steam room, sauna and fully equipped gym. Local transport links include the DLR from Bow Church, Circle, district and Hammersmith and city lines from Bow Road and Central and district lines from Mile End station. There are also various bus routes immediately outside the development.

- One-bedroom Mezzanine Apartment
- Private Development
- 24hour Concierge and Security
- Leisure Facilities
- South-East Facing
- Large, Original Factory Window

Oliver Jaques Bow Sales
020 8980 0999

Email southeast@o-j.co.uk

Unit A Arlington Building, London, E3 2UB

web <https://www.o-j.co.uk/>

Every care has been taken with the preparation of this brochure but it is for general guidance only and complete accuracy cannot be guaranteed. If there is any point, which is of importance professional verification should be sought. This brochure does not constitute a contact or part of a contract. We are not qualified to verify tenure of property. Prospective purchasers should seek clarification from their solicitor or verify the tenure of this property for themselves by visiting www.gov.uk/government/organisations/land-registry. The mention of any appliances, fixtures or fittings does not imply they are in full working order. Photographs are reproduced for general information and it cannot be inferred that any item shown is included in the sale. All dimensions are approximate. Walking times are taken from Google Maps and measured from the centre of the postcode, which may differ from the individual property. We routinely refer clients to Chancery Mortgage Services Ltd. It is your decision whether you choose to deal with Chancery Mortgage Services Ltd. In making that decision, you should know that we receive an annual payment benefits from Chancery Mortgage Services Ltd, equating to approximately £220 per referral

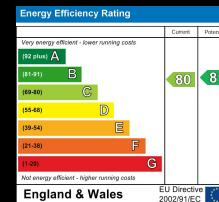

Fairfield Road, London, E3

Approximate Area = 450 sq ft / 41.8 sq m (excludes void)

For identification only - Not to scale

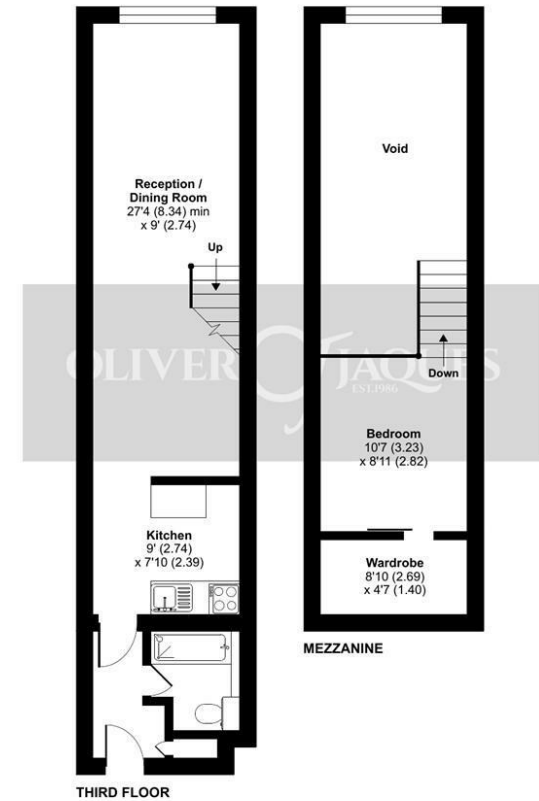

Floor plan produced in accordance with RICS Property Measurement Standards incorporating International Property Measurement Standards (IPMS2 Residential). © rnhccom 2023. Produced for Oliver Jaques. REF: 1061914

Tenure: Leasehold
Ground Rent: TBC
Service Charge: TBC
Lease Expires: TBC
Shared Ownership: No
Council Tax Band: Tower Hamlets London Borough Council (Band C)
£TBC