



# Lexington Building, Bow Quarter

Asking Price £500,000 Leasehold

**OLIVER *OJ* JAQUES**  
EST.1986



## Lexington Building, Bow Quarter

Set within the Bow Quarter development, this grade II listed apartment is arranged over two levels offering double height ceilings, a large factory window and an open plan kitchen / reception room / Bedroom. Overlooking the reception area is the mezzanine level galleried bedroom complete with walk-in wardrobe and study area. This property is in an excellent condition and would be ready to move into. The apartment benefits from a 24 hour concierge service, an on-site convenience store, and exclusive access to the leisure centre with a gym, pool, jacuzzi and sauna.

Bow Church DLR and Bow Road stations within 5 minutes walking distance along with other popular amenities.

- Two Bedroom Apartment
- Double Height Ceilings
- 24 Hour Concierge
- EPC Rating B
- Factory Style Window
- Swimming Pool & Gym

Oliver Jaques Bow Sales  
020 8980 0999

Email [southeast@o-j.co.uk](mailto:southeast@o-j.co.uk)

Unit A Arlington Building, London, E3 2UB

web <https://www.o-j.co.uk/>

Every care has been taken with the preparation of this brochure but it is for general guidance only and complete accuracy cannot be guaranteed. If there is any point, which is of importance professional verification should be sought. This brochure does not constitute a contract or part of a contract. We are not qualified to verify tenure of property. Prospective purchasers should seek clarification from their solicitor or verify the tenure of this property for themselves by visiting [www.gov.uk/government/organisations/land-registry](http://www.gov.uk/government/organisations/land-registry). The mention of any appliances, fixtures or fittings does not imply they are in full working order. Photographs are reproduced for general information and it cannot be inferred that any item shown is included in the sale. All dimensions are approximate. Walking times are taken from Google Maps and measured from the centre of the postcode, which may differ from the individual property. We routinely refer clients to Chancery Mortgage Services Ltd. It is your decision whether you choose to deal with Chancery Mortgage Services Ltd. In making that decision, you should know that we receive an annual payment benefits from Chancery Mortgage

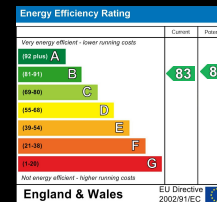

## Bow Quarter, Fairfield Road, London, E3

Approximate Area = 776 sq ft / 72.0 sq m (Excludes Galleried Area)

For identification only - Not to scale

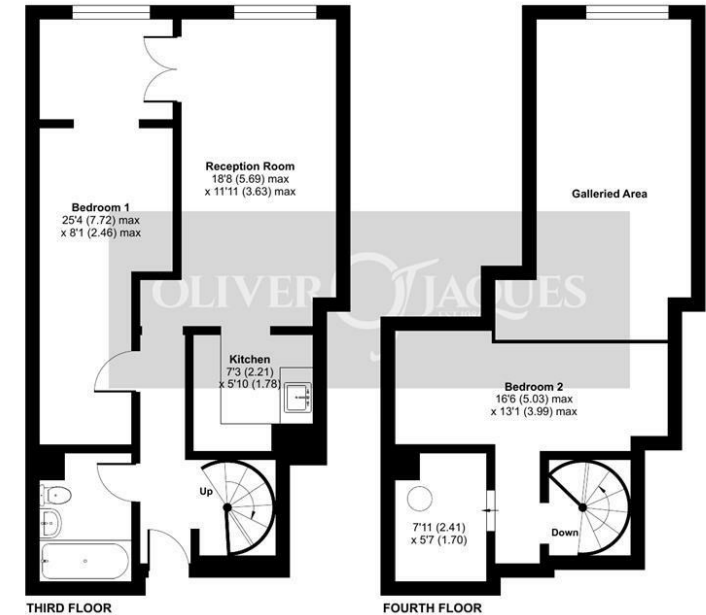

Floor plan produced in accordance with RICS Property Measurement Standards incorporating International Property Measurement Standards (IPMS2 Residential). © rnhccom 2023. Produced for Oliver Jaques. REF: 955075

**Tenure:** Leasehold

**Ground Rent:** £150 pa

**Service Charge:** £5,500 pa

**Lease Expires:** 2113

**Shared Ownership:** No

**Council Tax Band:** Tower Hamlets London Borough Council (Band D)

£1,581.02 pa