



Rope Street, Surrey Quays

Asking Price £330,000 Leasehold

OLIVER *OJ* JAQUES
EST.1986



Rope Street, Surrey Quays

A larger than average studio apartment, spanning 497sqft (46.2sqm), enjoying views across the marina from its second floor elevation. The property offers the original "studio-style" living with wide, bright, open spaces; the L shape affords the bedroom area privacy and also offers development potential to create a separate bedroom as at least one other in the development has done. The property forms part of Swedish Quays, a Grade II listed quayside building which dates from 1988 and is listed by English Heritage as "a successful example of townscape created by Gordon Cullen, Britain's most influential planning theorist and architectural illustrator of the post-war period." It is a design that has stood the test of time and is today known as an iconic stamp on the Surrey Quay skyline.

AGENT NOTE - The vendors are in the process of purchasing the freehold with the other residents in the building, this will provide the apartment with a share of freehold (including a longer lease) and peppercorn rent. They have recently started the process and anticipate this being completed prior to any sale, if you would like further information, please contact the agent.

- Second Floor Apartment
- Direct Views Over Marina
- Allocated Parking Bay
- Open Planned Living
- Iconic Grade II Listed Building
- 46.2sqm (497sqft)

Oliver Jaques Surrey Quays Sales
0207 231 5050

Email southeast@o-j.co.uk

229/331 Lower Road, Surrey Quay, London, SE16 2LW

web <https://www.o-j.co.uk>

Every care has been taken with the preparation of this brochure but it is for general guidance only and complete accuracy cannot be guaranteed. If there is any point, which is of importance professional verification should be sought. This brochure does not constitute a contact or part of a contract. We are not qualified to verify tenure of property. Prospective purchasers should seek clarification from their solicitor or verify the tenure of this property for themselves by visiting www.gov.uk/government/organisations/land-registry. The mention of any appliances, fixtures or fittings does not imply they are in full working order. Photographs are reproduced for general information and it cannot be inferred that any item shown is included in the sale. All dimensions are approximate. Walking times are taken from Google Maps and measured from the centre of the postcode, which may differ from the individual property. We routinely refer clients to Chancery Mortgage Services Ltd. It is your decision whether you choose to deal with Chancery Mortgage Services Ltd. In making that decision, you should know that we receive an annual payment benefits from Chancery Mortgage Services Ltd, equating to approximately £220 per referral

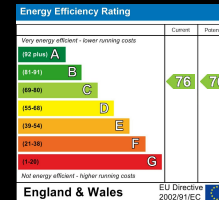

Rope Street, London, SE16

Approximate Area = 497 sq ft / 46.2 sq m
For identification only - Not to scale

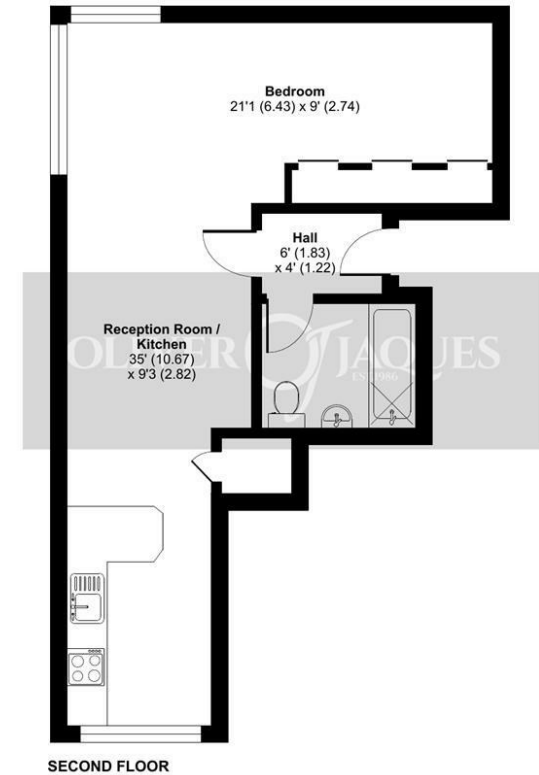

Floor plan produced in accordance with RICS Property Measurement Standards incorporating International Property Measurement Standards (IPMS2 Residential). © rnichecom 2024. Produced for Oliver Jaques. REF: 1120501

Tenure: Leasehold
Ground Rent: £50 pa
Service Charge: £1,382.26 pa
Lease Expires: 25th March 2113
Shared Ownership: No
Council Tax Band: Southwark London Borough Council (Band C)
 £1,593.76 pa