



Columbia Point Canada Estate, London

London

£330,000

OLIVER *OJ* JAQUES
EST. 1986

Columbia Point Canada Estate, London

A well presented spacious two bedroom, one bathroom apartment located on the 18th floor. The property offers stunning views of the river and towards the city.

Council Tax band: B

Tenure: Leasehold

Lease Expiry 17/09/2204

EPC Energy Efficiency Rating: C

EPC Environmental Impact Rating: C

- 0.2 Miles From Canada Water Station
- Two Bedroom Apartment
- Eighteenth Floor
- 0.4 Miles From Southwark Park
- Secure Entry System
- Heating And Hot Water Included Within Service Charge



Columbia Point, Canada Estate, London, SE16

Approximate Area = 645 sq ft / 60 sq m
For identification only - Not to scale

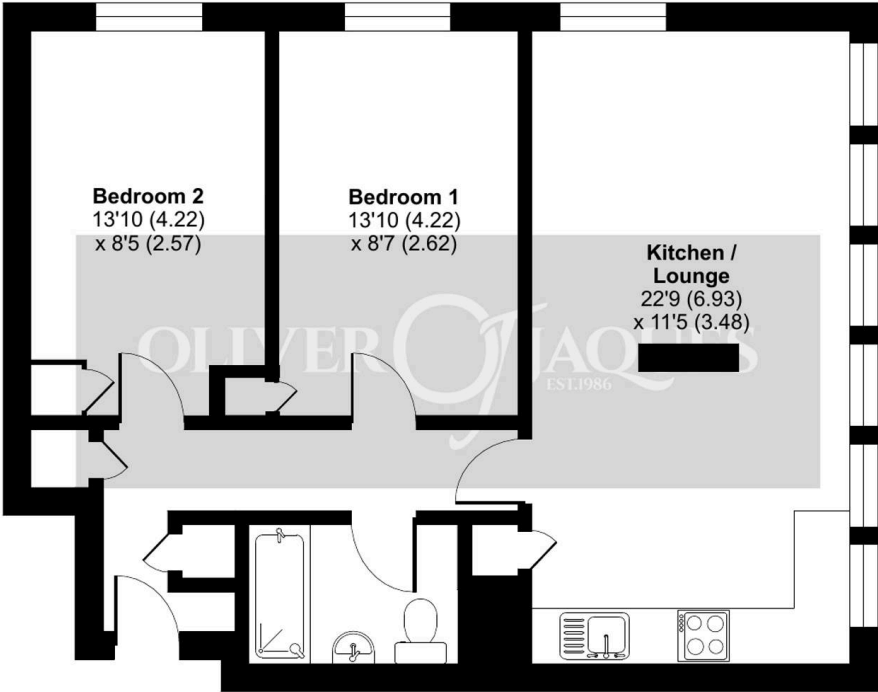

EIGHTEENTH FLOOR



Floor plan produced in accordance with RICS Property Measurement 2nd Edition, Incorporating International Property Measurement Standards (IPMS2 Residential). © nichecom 2025. Produced for Oliver Jaques. REF: 1228747



Oliver Jaques

Oliver Jaques, 229-231 Lower Road – SE16 2LW

02072315050 • southeast@o-j.co.uk • o-j.co.uk/

Every care has been taken with the preparation of this brochure but it is for general guidance and complete accuracy can't be guaranteed. Prospective purchasers should seek clarification from their solicitor. The mention of any appliances fixtures or fittings does not imply they are in working order.