



Varcoe Road, London

London

Guide Price £300,000

OLIVER *OJ* JAQUES
EST. 1986

Apartment

1 Varcoe Road, London

PRIVATE ROOF TERRACE - This impressive one bedroom first floor apartment includes a private roof terrace! The accommodation includes an open plan lounge/diner/kitchen, bedroom and shower room. The building includes two communal roof terraces with fabulous views and a communal workroom (ideal space for working from home). Located very close to South Bermondsey Station providing access to Central London within 4 minutes, we would highly recommend an internal viewing.

Council Tax band: C

Tenure: Leasehold

Lease expiry: 25/11 / 2144

EPC Energy Efficiency Rating: B

EPC Environmental Impact Rating: B

- Modern Apartment with PRIVATE ROOF TERRACE
- Modern Fitted Shower Room
- One Double Bedroom
- Open Plan Lounge/Diner/Kitchen
- Bermondsey Location in Close Proximity to Central London



Varcoe Road, London, SE16

Approximate Area = 423 sq ft / 39.4 sq m

For identification only - Not to scale

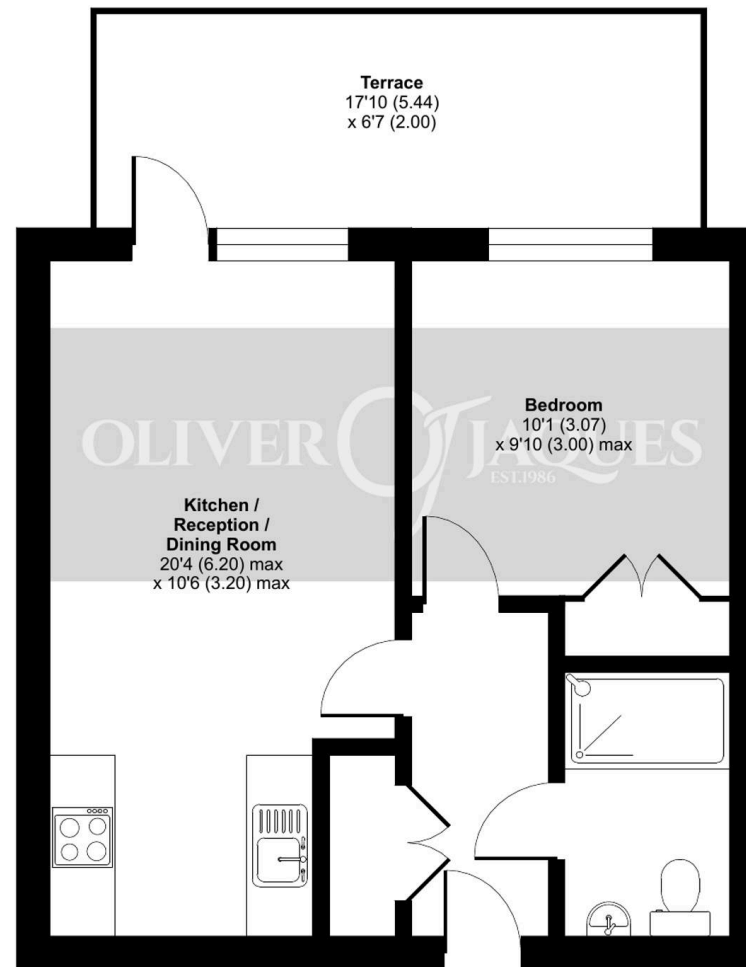

SIXTH FLOOR



Floor plan produced in accordance with RICS Property Measurement Standards incorporating International Property Measurement Standards (IPMS2 Residential). © nchecon 2024. Produced for Oliver Jaques. REF: 1182884



Oliver Jaques

Oliver Jaques, 229-231 Lower Road – SE16 2LW

02072315050 • southeast@o-j.co.uk • o-j.co.uk/

Every care has been taken with the preparation of this brochure but it is for general guidance and complete accuracy can't be guaranteed. Prospective purchasers should seek clarification from their solicitor. The mention of any appliances fixtures or fittings does not imply they are in working order.