



Rotherhithe Street, Rotherhithe  
£516 Per Calendar Month

OLIVER *OJ* JAQUES  
EST. 1986



## Rotherhithe Street, Rotherhithe SE16

Having recently undergone a period of refurbishment works including a new bathroom suite with walk-in shower, this bright and spacious one bedroom maisonette with gated off-street parking is available for an early August occupation on an unfurnished basis. The property boasts a large lounge/dining area leading to a private patio garden and further benefits a large double bedroom, fully fitted kitchen and electric heating. Situated within walking distance of the amenities of Canada Water and Surrey Quays, the property is serviced by the C10 and 381/N381 bus routes, as well as London Overground services at nearby Rotherhithe station.

- One Bedroom Maisonette
- Gated Off Street Parking
- Council Tax Band D
- Private Patio Garden
- EPC Rating D
- £1,846 Deposit Amount

Oliver Jaques Surrey Quays Lettings  
020 7231 5050

Email [southeast@o-j.co.uk](mailto:southeast@o-j.co.uk)

229/231 Lower Road, Surrey Quays, London, SE16 2LW

web <https://www.o-j.co.uk>

Every care has been taken with the preparation of this brochure but it is for general guidance only and complete accuracy cannot be guaranteed. If there is any point, which is of importance professional verification should be sought. This brochure does not constitute a contract or part of a contract. We are not qualified to verify tenure of property. Prospective purchasers should seek clarification from their solicitor or verify the tenure of this property for themselves by visiting [www.gov.uk/government/organisations/land-registry](http://www.gov.uk/government/organisations/land-registry). The mention of any appliances, fixtures or fittings does not imply they are in full working order. Photographs are reproduced for general information and it cannot be inferred that any item shown is included in the sale. All dimensions are approximate. Walking times are taken from Google Maps and measured from the centre of the postcode, which may differ from the individual property. We always refer prospective buyers to our panelled conveyancers and Chancery Mortgage Services Ltd. It is your decision whether to use them. Should you decide to do so you should know that we could receive a referral fee from them for recommending them to you.

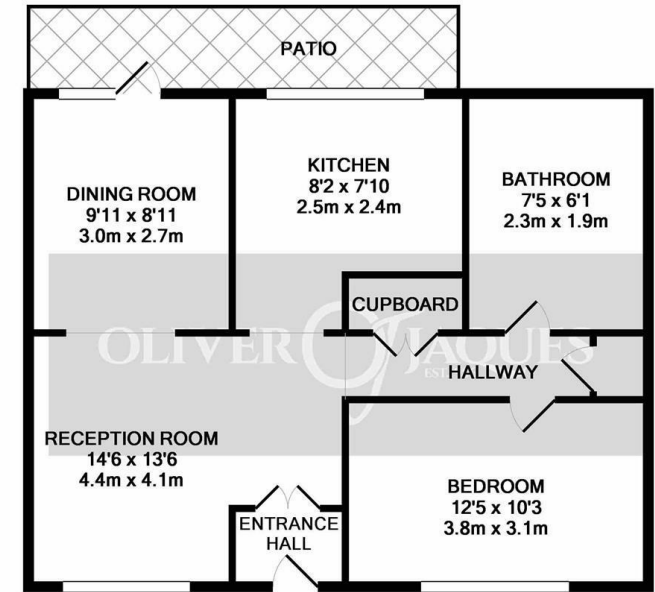

Whilst every attempt has been made to ensure the accuracy of the floor plan contained here, measurements of doors, windows, rooms and any other items are approximate and no responsibility is taken for any error, omission, or mis-statement. This plan is for illustrative purposes only and should be used as such by any prospective purchaser. The services, systems and appliances shown have not been tested and no guarantee as to their operability or efficiency can be given  
Made with Metropix ©2019

