



# 4 Gullivers Walk, London

Asking Price £400,000 Leasehold

OLIVER  JAUQUES  
EST.1986





## 4 Gullivers Walk, London

At 555sqft, this naturally bright first floor apartment forms part of Galliard's landmark development; Gullivers Walk. The property enjoys a fully transferable new homes guarantee along with a concierge service and landscaped communal gardens. The property is immaculately presented with hard wood flooring throughout the living areas, the windows all extend floor to ceiling exacerbating the feel of space and light, while the south facing balcony makes a great space in which to while away the summer evenings. Offered for sale on a 993-year lease, this great starter home is within half mile of Surrey Quays' Overground Line station and just 0.3 miles to the Greenland Pier offering Thames Clipper services to Canary Wharf and beyond.

- First Floor Apartment
- Communal Gardens
- 993 Year Lease
- South Facing Private Balcony
- Concierge Service
- EPC Rating B

Oliver Jaques Surrey Quays Sales  
0207 231 5050

Email [southeast@o-j.co.uk](mailto:southeast@o-j.co.uk)

229/331 Lower Road, Surrey Quay, London, SE16 2LW

web <https://www.o-j.co.uk>

Every care has been taken with the preparation of this brochure but it is for general guidance only and complete accuracy cannot be guaranteed. If there is any point, which is of importance professional verification should be sought. This brochure does not constitute a contract or part of a contract. We are not qualified to verify tenure of property. Prospective purchasers should seek clarification from their solicitor or verify the tenure of this property for themselves by visiting [www.gov.uk/government/organisations/land-registry](http://www.gov.uk/government/organisations/land-registry). The mention of any appliances, fixtures or fittings does not imply they are in full working order. Photographs are reproduced for general information and it cannot be inferred that any item shown is included in the sale. All dimensions are approximate. Walking times are taken from Google Maps and measured from the centre of the postcode, which may differ from the individual property. We routinely refer clients to Chancery Mortgage Services Ltd. It is your decision whether you choose to deal with Chancery Mortgage Services Ltd. In making that decision, you should know that we receive an annual payment benefits from Chancery Mortgage Services Ltd, equating to approximately £220 per referral

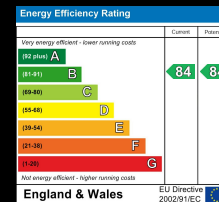

## Harbourside Court, Gullivers Walk, London, SE8

Approximate Area = 555 sq ft / 51.6 sq m  
For identification only - Not to scale

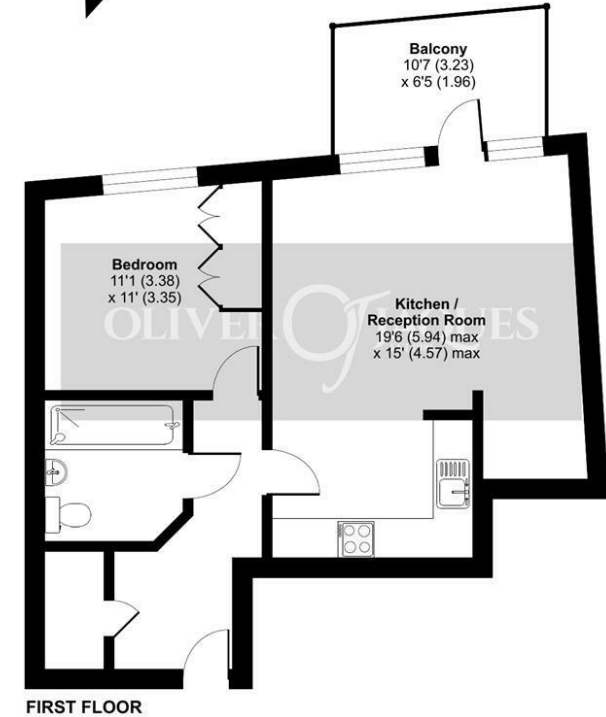

Floor plan produced in accordance with RICS Property Measurement Standards incorporating International Property Measurement Standards (IPMS2 Residential). © rinchecom 2023. Produced for Oliver Jaques. REF: 1146103

**Tenure:** Leasehold  
**Ground Rent:** £400 pa  
**Service Charge:** £2,872 pa  
**Lease Expires:** 993 Years Remaining  
**Shared Ownership:** No  
**Council Tax Band:** Lewisham London Borough Council (Band C)  
 £1,811.54 pa