



Transom Close, Surrey Quays

Asking Price £335,000 Leasehold

OLIVER  JAUQUES
EST. 1986



Transom Close, Surrey Quays

A beautifully presented starter home, located on South Dock's pretty quayside, which enjoys peaceful views across the marina from the living areas. Developed by Fairview Homes in the 1990s, Transom Close is a leafy row of low-rise apartment blocks benefiting from secure intercom system and residents' parking. This property features a spacious bedroom and a distinct lounge area. The windows were upgraded to uPVC framed double glazing in 2019, and the flooring predominantly boasts a wood effect finish. With 160 years left on the lease, this property offers a stress-free investment opportunity in the desirable dockside area of Surrey Quays.

- EPC Rating: B
- Fully Double Glazed
- Extended Lease
- Leafy Cul-de-Sac Setting
- One double bedroom
- Direct views over Marina

Oliver Jaques Surrey Quays Sales
0207 231 5050

Email southeast@o-j.co.uk

229/331 Lower Road, Surrey Quay, London, SE16 2LW

web <https://www.o-j.co.uk>

Every care has been taken with the preparation of this brochure but it is for general guidance only and complete accuracy cannot be guaranteed. If there is any point, which is of importance professional verification should be sought. This brochure does not constitute a contact or part of a contract. We are not qualified to verify tenure of property. Prospective purchasers should seek clarification from their solicitor or verify the tenure of this property for themselves by visiting www.gov.uk/government/organisations/land-registry. The mention of any appliances, fixtures or fittings does not imply they are in full working order. Photographs are reproduced for general information and it cannot be inferred that any item shown is included in the sale. All dimensions are approximate. Walking times are taken from Google Maps and measured from the centre of the postcode, which may differ from the individual property. We routinely refer clients to Chancery Mortgage Services Ltd. It is your decision whether you choose to deal with Chancery Mortgage Services Ltd. In making that decision, you should know that we receive an annual payment benefits from Chancery Mortgage Services Ltd, equating to approximately £220 per referral

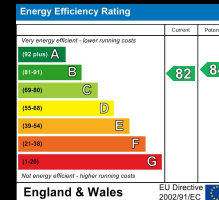

Transom Close, SE16

Approximate Area = 437 sq ft / 40.6 sq m
For identification only - Not to scale

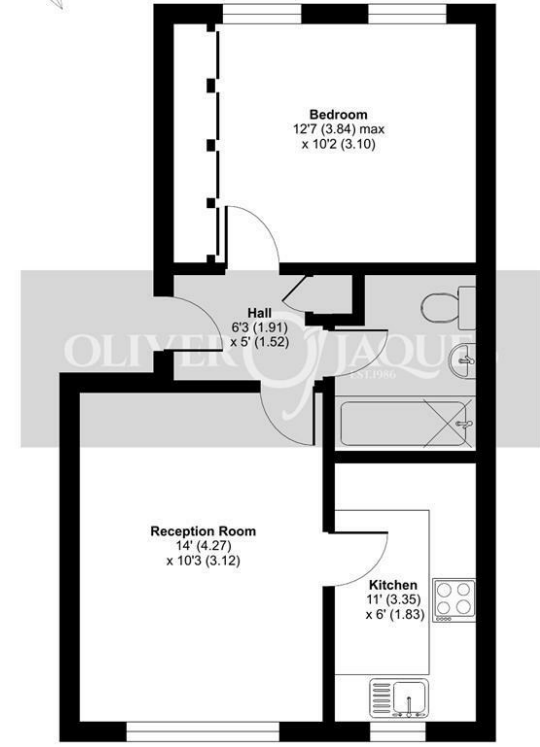

FIRST FLOOR



Floor plan produced in accordance with RICS Property Measurement Standards incorporating International Property Measurement Standards (IPMS2 Residential). © rnichecom 2024. Produced for Oliver Jaques. REF: 1109908

Tenure: Leasehold

Ground Rent: n/a

Service Charge: £1,572 pa

Lease Expires: 23rd June 2184

Shared Ownership: No

Council Tax Band: Southwark London Borough Council (Band C)

£1,593.76 pa