



Tilbury House, Myers Lane

Asking Price £225,000 Leasehold

OLIVER *OJ* JAQUES
EST. 1986



Tilbury House, Myers Lane

This peacefully situated residence in Tilbury House presents an affordable opportunity to step onto the continuously appreciating property ladder. Tilbury Court resides on Myers Lane, forming part of a larger Fairview Homes-built development of low-rise apartments established in the early 1990s on former Millwall FC land. Surrounding the area are the lush green expanses of Bridgehouse Meadows on one side and the charming Victorian streets of the Hatcham Conservation area on the other. Conveniently accessible to South Bermondsey, New Cross, and New Cross Gate stations by foot, the property is just a brief three-minute stroll from the proposed Surrey Canal Road station site, which is poised to enhance future appreciation.

- Secure Entry-Phone System for Added Safety
- Ideal as a First Home for Buyers
- Close to Local Amenities
- Situated in a Tranquil Residential Cul-de-sac
- Private Development from Fairview Homes
- Separate Kitchen

Oliver Jaques Surrey Quays Sales
0207 231 5050

Email southeast@o-j.co.uk

229/331 Lower Road, Surrey Quay, London, SE16 2LW

web <https://www.o-j.co.uk>

Every care has been taken with the preparation of this brochure but it is for general guidance only and complete accuracy cannot be guaranteed. If there is any point, which is of importance professional verification should be sought. This brochure does not constitute a contact or part of a contract. We are not qualified to verify tenure of property. Prospective purchasers should seek clarification from their solicitor or verify the tenure of this property for themselves by visiting www.gov.uk/government/organisations/land-registry. The mention of any appliances, fixtures or fittings does not imply they are in full working order. Photographs are reproduced for general information and it cannot be inferred that any item shown is included in the sale. All dimensions are approximate. Walking times are taken from Google Maps and measured from the centre of the postcode, which may differ from the individual property. We routinely refer clients to Chancery Mortgage Services Ltd. It is your decision whether you choose to deal with Chancery Mortgage Services Ltd. In making that decision, you should know that we receive an annual payment benefits from Chancery Mortgage Services Ltd, equating to approximately £220 per referral

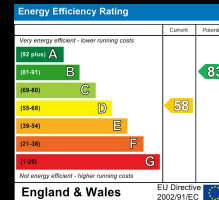

Myers Lane, SE14

Approximate Area = 322 sq ft / 29.9 sq m
For identification only - Not to scale

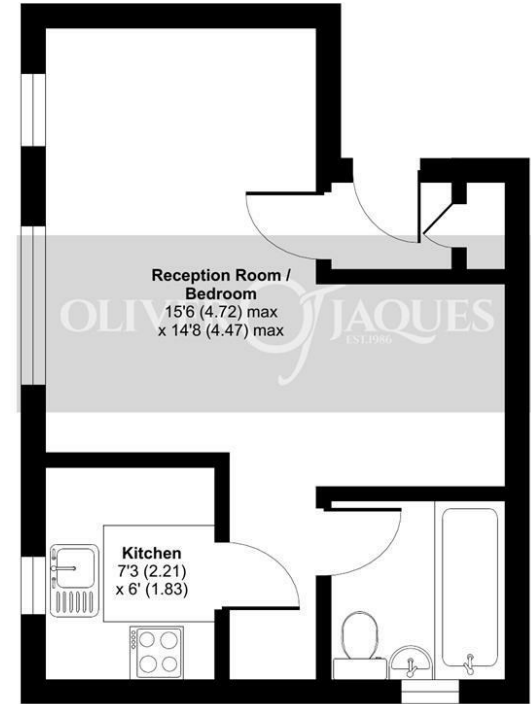

FIRST FLOOR



Floor plan produced in accordance with RICS Property Measurement Standards incorporating International Property Measurement Standards (IPMS2 Residential). © rnhccom 2024. Produced for Oliver Jaques. REF: 1091671

Tenure: Leasehold

Ground Rent: £234 pa

Service Charge: £2,000 pa

Lease Expires: 17th August 2110

Shared Ownership: No

Council Tax Band: Lewisham London Borough Council (Band B)

£1,585.09