



**Sally Botham**  
ESTATES



## **WARNEY LODGE**

**Old Road, Darley Dale, DE4 2ER**  
**£450,000**

Spacious detached bungalow in need of full renovation, set in approx 0.6 acres of level garden. Ideal for redevelopment (subject to planning consent) or reconfiguration. Popular semi rural location within easy reach of amenities on the edge of the Peak District. Internal inspection is not possible.



01629 760899  
sallybotham.co.uk





**TENURE** Freehold  
**COUNCIL TAX BAND** (Correct at the time of publication) D

Approx Gross Internal Area  
128 sq m / 1381 sq ft

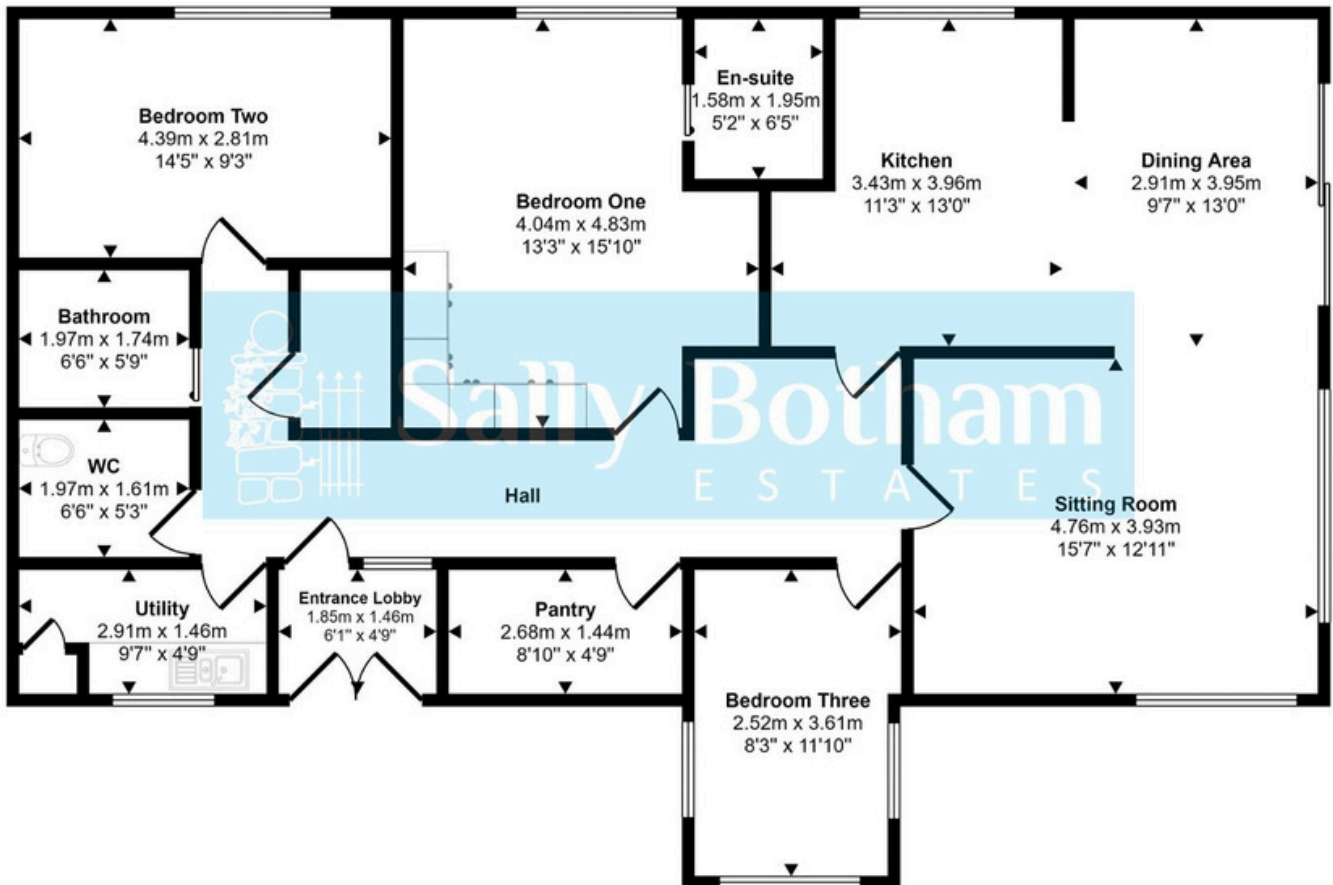

Floorplan

This floorplan is only for illustrative purposes and is not to scale. Measurements of rooms, doors, windows, and any items are approximate and no responsibility is taken for any error, omission or mis-statement. Icons of items such as bathroom suites are representations only and may not look like the real items. Made with Made Snappy 360.

**DISCLAIMER**

All measurements in these details are approximate. None of the fixed appliances or services have been tested and no warranty can be given to their condition. The deeds have not been inspected by the writers of these details. These particulars are produced in good faith with the approval of the vendor but they should not be relied upon as statements or representations of fact and they do not constitute any part of an offer or contract.