

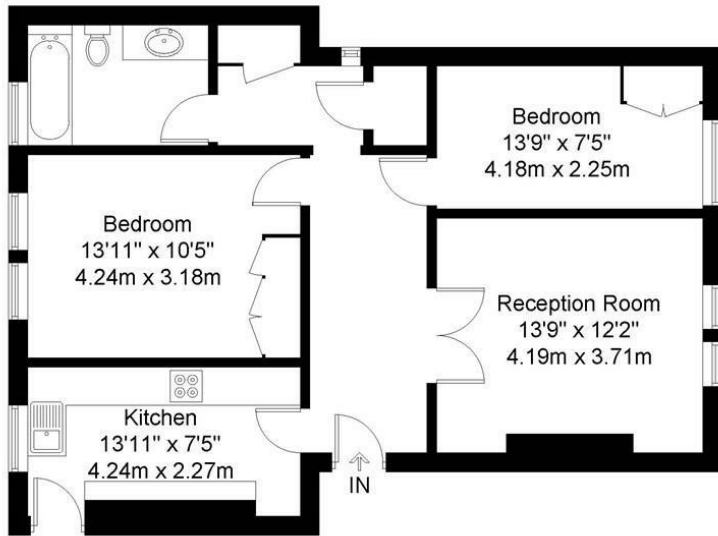

hausman
& holmes

Eagle Lodge, Golders Green Road, NW11
Asking Price £525,000



Second Floor

Eagle Lodge, Golders Green Road, NW11

Total Gross Internal Area = 72 sq m / 775 sq ft

All Measurements are approximate and for identification guideline purposes only, not to scale.
Compliant with the RICS code of measuring practice



020 8458 8555
 57 Golders Green Road
 London NW11
 info@hausmanandholmes.com



- 775 Sq. Ft.
- 2 Bedrooms
- Highly sought after purpose built block
- Garage
- Positioned in the heart of Golders Green
- Low out goings

Energy Efficiency Rating		Current	Potential
Very energy efficient - lower running costs			
(92 plus)	A		
(81-91)	B		
(69-80)	C		
(55-68)	D		
(39-54)	E		
(21-38)	F		
(1-20)	G		
Not energy efficient - higher running costs			
		63	81
England & Wales		EU Directive 2002/91/EC	

Compliant with RICS code of measuring practice, Particulars and floor plans are only a guide to the property and do not constitute or form part of any offer or contract and are not to be regarded as representation of fact. Any intending purchaser must satisfy themselves as to the accuracy of these particulars as they are given without responsibility. No person in the employment of Hausman and Holmes has any authority to make or give representation or warranty to properties being sold.