

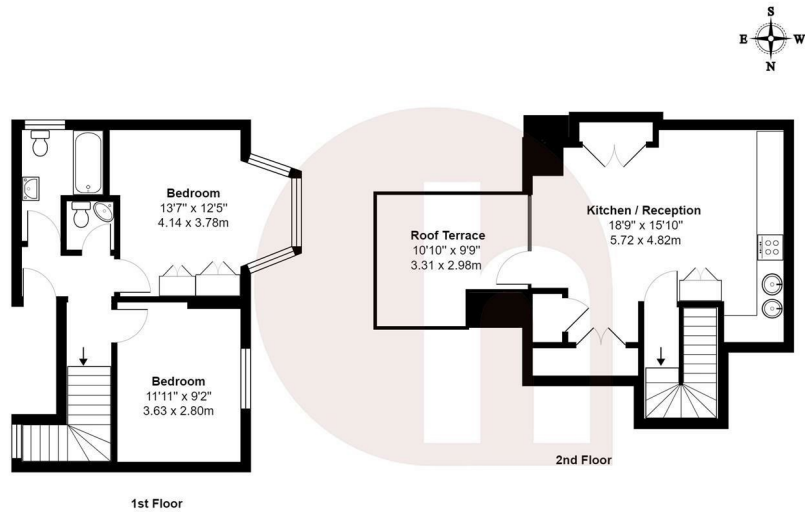

hausman
& holmes

Finchley Road, NW11

Asking Price £535,000



Finchley Road, London, NW11

Total Gross Area: 745 ft² ... 69.2 m²

All measurements are approximate and for identification guideline purposes only, not to scale. Compliant with the RICS code of measuring practice



- Two double bedrooms
- 745 sq ft and Long lease
- Off street parking

- Duplex on the 1st & 2nd Floors
- Exceptional roof terrace



020 8458 8555

57 Golders Green Road

London NW11

info@hausmanandholmes.com

Energy Efficiency Rating		Current	Potential
Very energy efficient - lower running costs			
92 plus) A			
(81-91) B			
(69-80) C			
(55-68) D			
(39-54) E			
(21-38) F			
(1-20) G			
Not energy efficient - higher running costs			
England & Wales		69	75
		EU Directive 2002/91/EC	

Compliant with RICS code of measuring practice, Particulars and floor plans are only a guide to the property and do not constitute or form part of any offer or contract and are not to be regarded as representation of fact. Any intending purchaser must satisfy themselves as to the accuracy of these particulars as they are given without responsibility. No person in the employment of Hausman and Holmes has any authority to make or give representation or warranty to properties being sold.