

HILL CRESCENT, HARROW



Three Bedroom Mid Terrace House

Guide Price £575,000

Description

Robertson Phillips are proud to present this modern three bedroom terrace home to the market. The house consists of a large bright and airy through lounge, leading out to a well maintained garden. A modern fitted kitchen, with worktops, storage cupboards and built in appliances, and a guest WC to the rear. On the first floor you have two spacious bedrooms with plenty of wardrobes space, and a single bedroom currently being used as an office, and a stylish tiled family bathroom. Further benefits include; Gas central heating, double glaze windows, ample storage & permit parking on the road.



Location: Hill Crescent is located close to Harrow town centre, which has an array of high street shops, Harrow-On-The-Hill station which serves the metropolitan line, local parks and great schools.





- *Three Bedroom Mid Terrace House*
- *Modern Fitted Kitchen*
- *Offered For Sale In Good Order Throughout*
- *Double Glazing*
- *Spacious Through Lounge*
- *Guest WC*
- *Gas Central Heating*
- *A Short Walk To Harrow Town Centre*



Additional Information

TENURE: FREEHOLD
LOCAL AUTHORITY: LONDON BOROUGH OF HARROW
ENERGY EFFICIENCY RATING: D

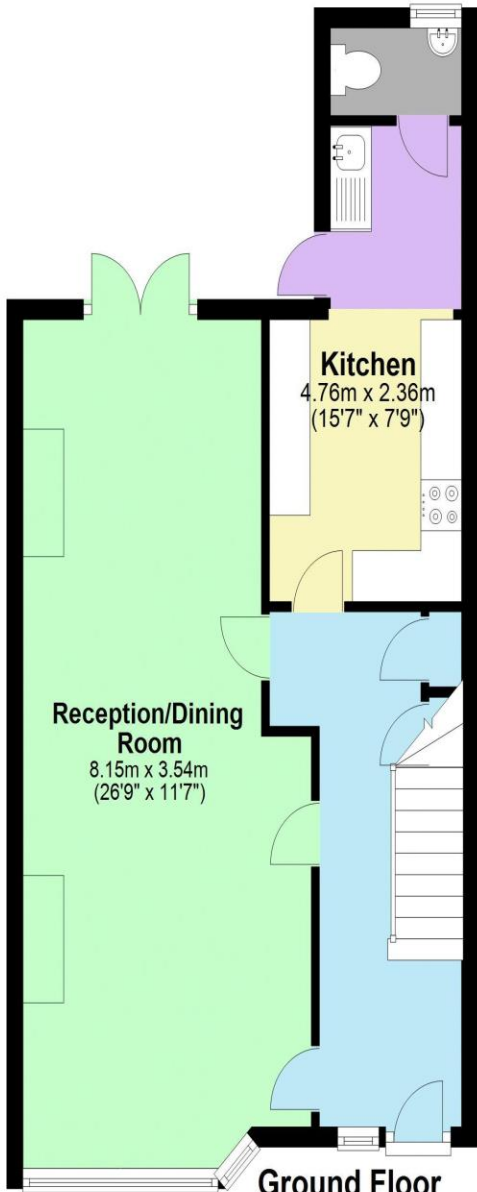

Approx. 48.3 sq. metres (520.2 sq. feet)

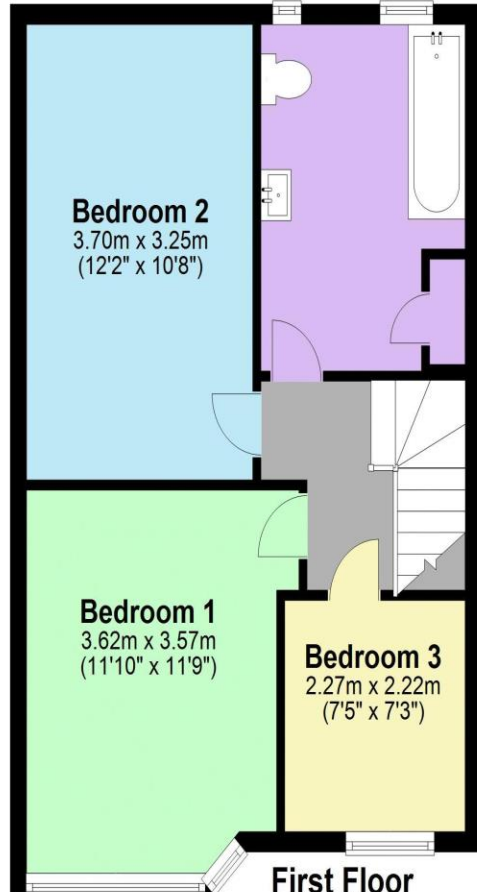

Approx. 43.6 sq. metres (469.7 sq. feet)

Total area: approx. 92.0 sq. metres (989.9 sq. feet)

Score	Energy rating	Current	Potential
92+	A		
81-91	B		84 B
69-80	C		
55-68	D	64 D	
39-54	E		
21-38	F		
1-20	G		



We have not sought to verify the legal title of the property, the existence of planning permissions and/or building regulation approvals and have been unable to check the working condition of any services or appliances.

Property layouts are for general guidance and are not drawn exactly to scale. Measurements are taken at the widest points and bays, alcoves, wardrobes etc. may not be shown.