

LOCKET ROAD, WEALDSTONE



Five Bedroom Mid Terrace House

Guide Price £575,000

Description

Robertson Phillips are proud to present this five bed, five bath mid terrace house onto the market. The property consists of; An entrance hall, a spacious kitchen/diner, a guest WC and a 30' Private Garden. This Mid terraced house has 5 double bedrooms and 5 Ensuite shower rooms, and has potential for a HMO License. Further Benefits include; Gas central heating, double glazed windows, ample storage, potential for off street parking and no upper chain



Location: Locket Road is walking distance from Harrow & Wealdstone station which provides access to both the Bakerloo and Underground. Wealdstone high street also has an array of eateries, amenities, gym and supermarkets. Also you are close to Belmont circle, Harrow Weald & Stanmore. A Good school catchment for St Joseph's catholic primary school and Belmont school.





- *Five Bedroom Mid Terrace House*
- *Spacious Kitchen/Diner*
- *Five Ensuite Shower Rooms*
- *Private Rear Garden*
- *Has Potential For HMO License*
- *Gas Central Heating & Double Glazing*
- *Guest Cloakroom*
- *Potential For Off Street Parking*



Additional Information

TENURE: FREEHOLD

LOCAL AUTHORITY: LONDON BOROUGH OF HARROW

ENERGY EFFICIENCY RATING: D

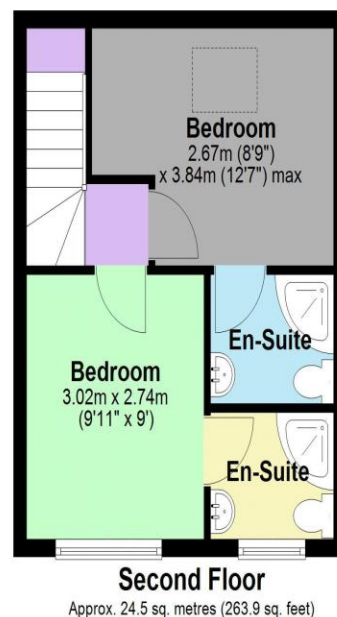
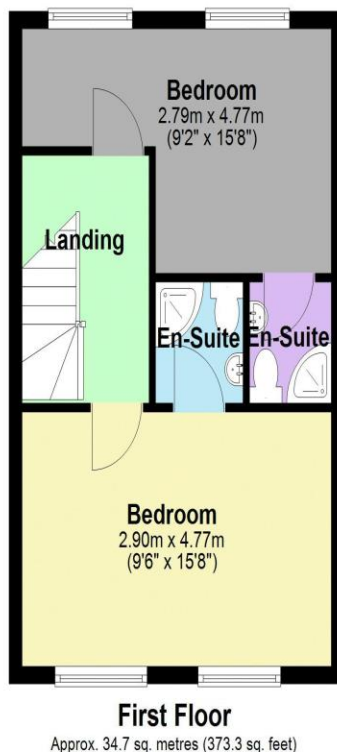
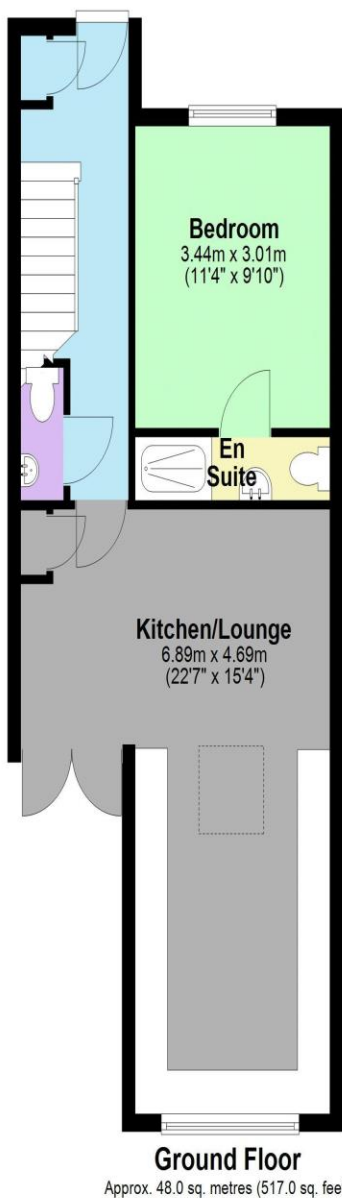

Total area: approx. 107.2 sq. metres (1154.2 sq. feet)

Score	Energy rating	Current	Potential
92+	A		
81-91	B		
69-80	C		
55-68	D		
39-54	E		
21-38	F		
1-20	G		



We have not sought to verify the legal title of the property, the existence of planning permissions and/or building regulation approvals and have been unable to check the working condition of any services or appliances.

Property layouts are for general guidance and are not drawn exactly to scale. Measurements are taken at the widest points and bays, alcoves, wardrobes etc. may not be shown.