

MANOR WAY, NORTH HARROW



Five/Six Bedroom Detached House

Guide Price £1,500,000

Description

Robertson Phillips are pleased to be able to offer for sale this 5/6 bedroom detached house with garage and carriage driveway occupying an impressive plot within easy reach of facilities within the North Harrow area. The property offers versatile accommodation over two floors with scope to expand to the side, rear and into the loft if required (stpp). With over 2000 sq ft of accommodation the house is ideal for a large family and benefits from gas central heating, majority double glazed windows, master bedroom with full en-suite facilities and four additional double bedrooms on the first floor. The expansive ground floor accommodation includes three reception rooms with one being ideal as a sixth bedroom if required. No Upper Chain is to be offered and as such, an internal inspection comes highly advised.





- *Five/Six bedroom fully detached house*
- *Offered for sale in very good order throughout*
- *No Upper Chain*
- *Garage to the side with carriage driveway*
- *Over 2000 sq ft in size*



Additional Information

TENURE: FREEHOLD

LOCAL AUTHORITY: LONDON BOROUGH OF HARROW

ENERGY EFFICIENCY RATING: TBC

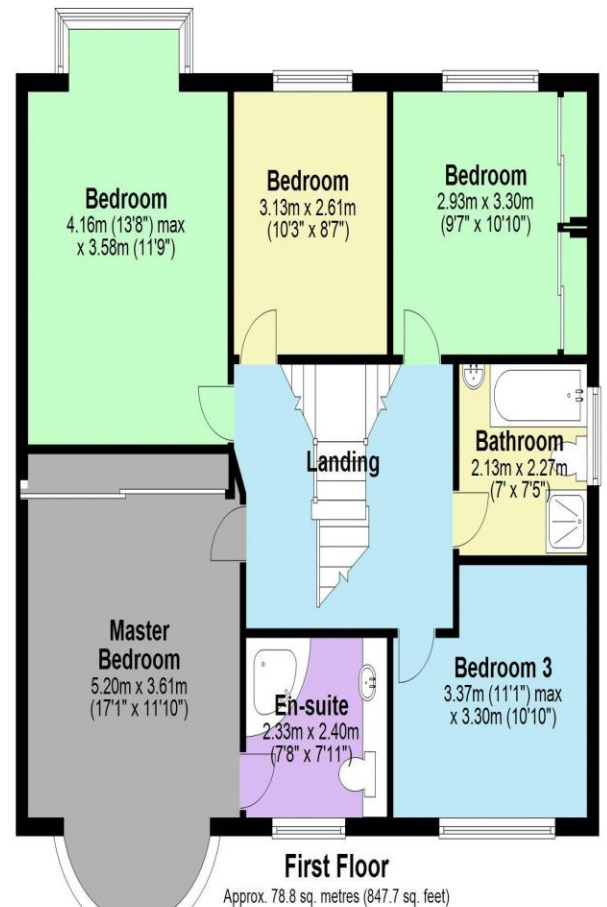

Total area: approx. 189.2 sq. metres (2036.4 sq. feet)



We have not sought to verify the legal title of the property, the existence of planning permissions and/or building regulation approvals and have been unable to check the working condition of any services or appliances.

Property layouts are for general guidance and are not drawn exactly to scale. Measurements are taken at the widest points and bays, alcoves, wardrobes etc. may not be shown.