



Deerhurst Chase, Bicknacre, Essex CM3 4XG
£1,350

Church & Hawes

Est. 1977

Estate Agents, Valuers, Letting & Management Agents

This three bedroom detached house is located in the favourable village of Bicknacre, which is nestled between Chelmsford and South Woodham Ferrers. The village offers a selection of local amenities including a highly regarded primary school, various shops and pubs. Main roads throughout the county are just a short drive away along with Sandon park and ride service to Chelmsford city centre. Internally the property is well presented, There is a lounge, kitchen diner, cloakroom to the ground floor and on the first floor are three bedrooms and bathroom. The property enjoys an enclosed garden, garage and driveway. Available now, with a minimum 12 month tenancy. Pets not considered. Energy rating C.

FIRST FLOOR

Bedroom One

13'10 x 8'5 (4.22m x 2.57m)

Bedroom Two

8'5 x 8'1 (2.57m x 2.46m)

Bedroom Three

8'1 x 5'3 (2.46m x 1.60m)

Bathroom/wc

GROUND FLOOR

Entrance Hall

Cloakroom

Kitchen Diner

11'4>8'5 x 10'8 (3.45m>2.57m x 3.25m)

Lounge

13'10 x 10'8 (4.22m x 3.25m)

EXTERIOR

Driveway to:

Garage

Rear Garden

approx 45' (approx 13.72m)

A Homelet reference will be undertaken, this will include details of your bank, employment, (accountant, if you are self employed) personal referees and any previous landlords, they will also carry out

a credit check. So as to satisfy the RIGHT TO RENT REGULATIONS, please supply your UK/EU PASSPORT, NON EU PASSPORT and RIGHT TO STAY VISA IF NON EU PASSPORT, DRIVING LICENCE and also a UTILITY BILL (not more than three months old) showing your current address. Before the application can begin we will need the above along with the PRE LET QUESTIONNAIRE, REFERENCE FORMS, PET / DECORATING request forms, HOLDING DEPOSIT and the ACKNOWLEDGMENT FORM returned fully completed and signed, without these we are unable to proceed with your proposed rental. COMPANY LETS ARE CHARGED AT £250 PER REFERENCE and a £160 CHARGE FOR THE PREPARATION OF THE TENANCY AGREEMENT. Your application will then be processed by a Reference Agency, we usually receive approval within two or three working days but please allow at least seven.

Church & Hawes require a holding deposit of one weeks rent in order to proceed with the application, this can be converted into part payment of the actual 5 week security deposit or the initial rental payment once the references and tenancy agreement have been approved. If the tenancy does not proceed due to no fault of your own (IE landlord deciding not to rent the property, the holding deposit will be returned) If the tenancy does not proceed due to your own circumstances including reference refusal, then the holding deposit will not be returnable.

Please see accompanying holding deposit acknowledgment sheet for further information.

One weeks holding deposit is the rent multiplied by 12 months and then divided by 52.

For example (Rent of £1,000 pcm x 12 = £12,000 divided by 52 = £230.77 holding deposit).

Properties are offered for letting on Assured Shorthold Tenancies of 6 or 12 months only. Subject to availability a further extension to the term may be arranged.

A security deposit, equal to 5 weeks of the total rent for the property, which is held during the tenancy as security for the rent (by Church and Hawes as stakeholder for security breaches of the tenancy agreement, therein defined, Church and Hawes are members of the tenancy deposit scheme), furniture, condition of the property and all breaches of the tenancy agreement. N.B. Both the deposit together with the first months rent, in advance are payable upon signing the Tenancy Agreement and must be cleared funds made by Electronic transfer (please ask for our bank details), Bankers Draft or

printed Building Society Cheque. Any personal cheque will necessitate 5 working days for it to clear before you will be able to take up occupancy. CASH IS NOT ACCEPTABLE.

Pets are usually not permitted but may be considered by special arrangement in individual cases

Church & Hawes Maldon are introducers; Reference Checks are not carried out within the office. Please complete the relative forms and return them to this office where we can forward the forms to the Reference Agency, or send directly to our Lettings Management office, 4 High Street, Maldon, CM9 6PJ. If you would like to contact our lettings manager for any reason please ask a member of staff and we will be pleased to supply you with contact details.

At Church & Hawes, our commitment to you is of paramount importance and to ensure this and to give you peace of mind, we are members of the National Association of Estate Agents (NAEA) The Property Ombudsman (TPOS), Office of Fair Trading (OFT), National Approved Lettings Scheme (NALS), Tenancy Dispute Scheme (TDS), Safe Agent and Property Mark Client Money Protection Scheme. Please contact your local office for further information.

Agents Notes

These particulars do not constitute any part of an offer or contract. All measurements are approximate. No responsibility is accepted as to the accuracy of these particulars or statements made by our staff concerning the above property. We have not tested any apparatus or equipment therefore cannot verify that they are in good working order. Any intending purchaser must satisfy themselves as to the correctness of such statements within these particulars. All negotiations to be conducted through Church and Hawes. No enquiries have been made with the local authorities pertaining to planning permission or building regulations. Any buyer should seek verification from their legal representative or surveyor.

Ground Floor

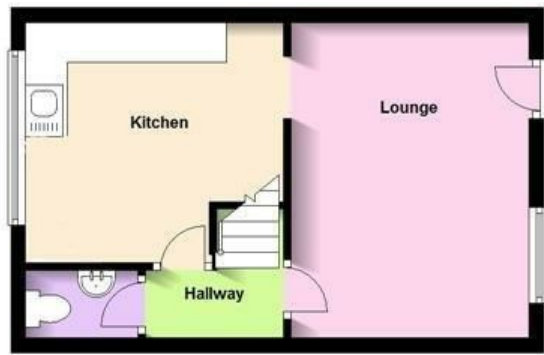

First Floor

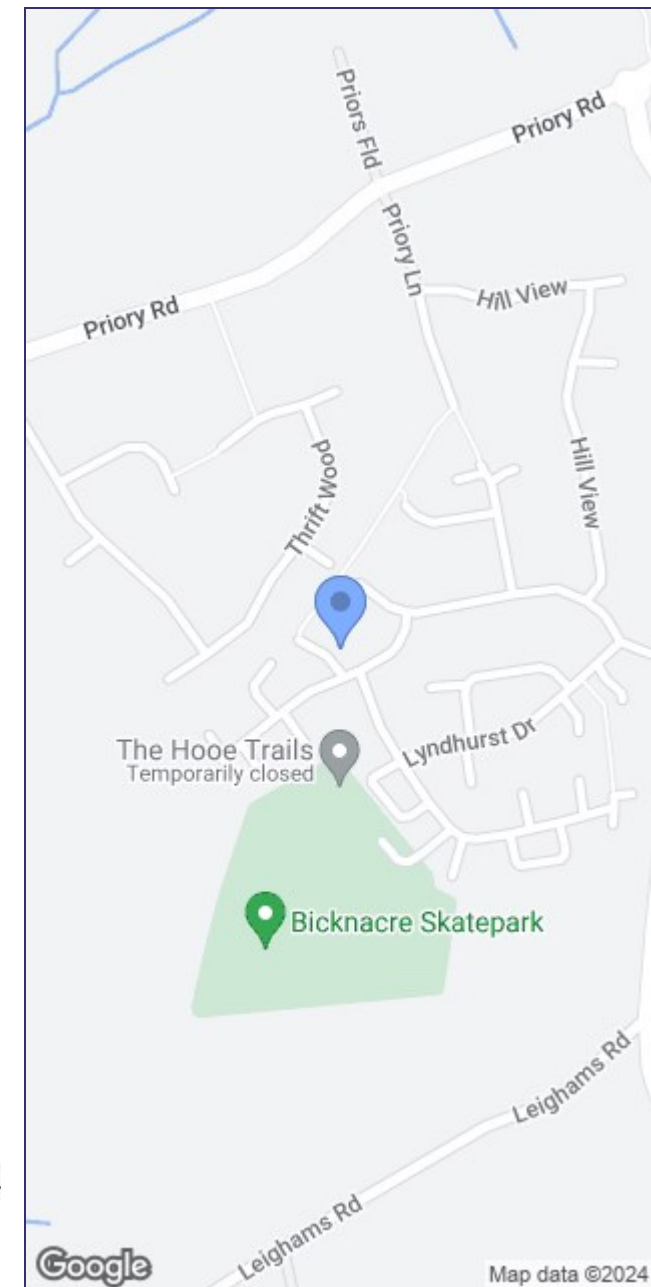
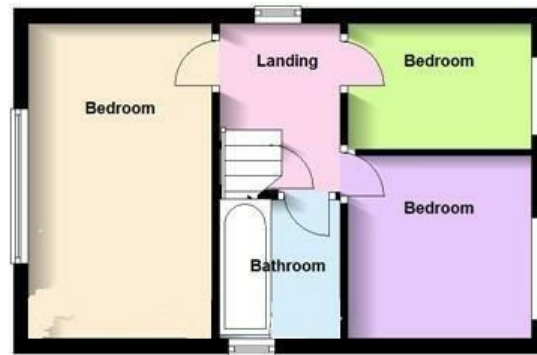

Produced by Property Trader 01245 323355Disclaimer:All floorplans are provided for informational and illustrative purposes only. Although we endeavour to provide truthful representation, we do not in any way warrant the accuracy of the floorplan information and the floorplan layout and measurements may contain errors and omissions. We are not liable for and do not accept any liability relating to any loss or damage suffered as a direct or indirect result of use of any information You or your advisors should conduct a careful, independent investigation of the property to determine to your satisfaction as to the suitability of the property for your full requirements.

Plan produced using The Mobile Agent.

