



Cobham Close, EN1 3SU  
Enfield







kings  
GROUP



## Cobham Close, EN1 3SU

Kings Group - Enfield Town are delighted to offer this CHAIN TWO BEDROOM FIRST FLOOR PURPOSE BUILT APARTMENT. Accommodation comprises spacious lounge, fitted kitchen, two good sized bedrooms, four piece bathroom suite and ample storage. The property also comes with one allocated parking space, communal grounds and also visitors parking is available. The property is next to Enfield playing fields and within walking distance of Southbury Road and Enfield Town Overground Stations with direct links to Liverpool Street and Seven Sisters. There are also excellent road links nearby including the A10, M25 and A406. The property is also within the catchment area of George Spicer Primary and Kingsmead schools.

£315,000



- Chain Free
- Allocated Parking
- Fitted Kitchen
- Ample Storage Space
- Easy Access to the A10/M25

- Two Bedroom First Floor Flat
- Bright and Airy Living Room
- Four Piece Bathroom Suite
- Gas Central Heating
- Within Close Proximity of Enfield Town Centre and Station

### Hallway

Carpeted flooring, Two storage cupboards, Smoke alarm

### Living Room 10'66 x 18'42 (3.05m x 5.49m)

Double glazed windows to the front and side aspect, Coved ceiling, Double radiators, Laminate flooring, Power points

### Kitchen 5'87 x 10'15 (1.52m x 3.05m)

Double glazed window to the side aspect, Laminate flooring, A range of base and wall units with roll top work surfaces, Integrated cooker with gas hob and electric oven, Power points, Plumbing for washing machine

### Bathroom 7'93 x 8'54 (2.13m x 2.44m)

Spotlights, Panel enclosed bath, Shower cubicle, Low level WC, Wash basin with mixer tap, Shaver point, Lino flooring

### Bedroom 1 8'50 x 12'53 (2.44m x 3.66m)

Double glazed window to the front aspect, Double radiator, Carpeted flooring, Built in wardrobes, Power points

### Bedroom 2 6'13 x 9'14 (1.83m x 2.74m)

Double glazed window to the front aspect, Carpeted flooring, Power points













# GROUND FLOOR

Energy Efficiency Rating		Current	Potential
Very energy efficient - lower running costs			
(92 plus) A			
(81-91) B			
(69-80) C			
(55-68) D			
(39-54) E			
(21-38) F			
(1-20) G			
Not energy efficient - higher running costs			
England & Wales		EU Directive 2002/91/EC	

Environmental Impact (CO <sub>2</sub> ) Rating		Current	Potential
Very environmentally friendly - lower CO <sub>2</sub> emissions			
(81-91) A			
(69-80) B			
(55-68) C			
(39-54) D			
(21-38) E			
(1-20) F			
(1-20) G			
Not environmentally friendly - higher CO <sub>2</sub> emissions			
England & Wales		EU Directive 2002/91/EC	

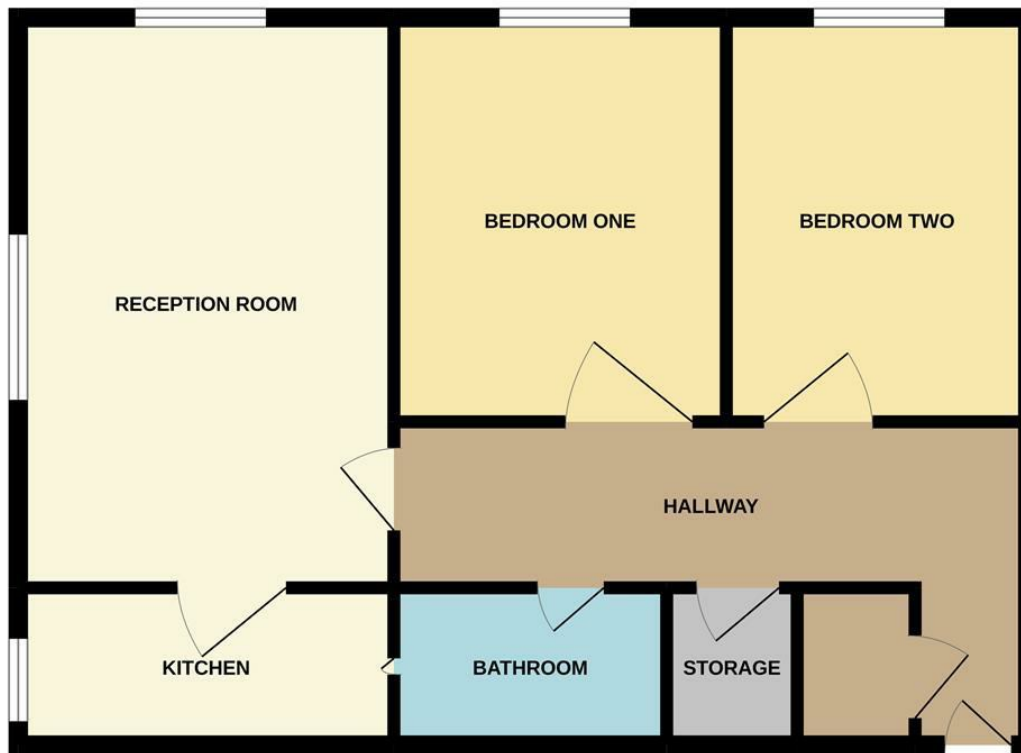

Whilst every attempt has been made to ensure the accuracy of the floorplan contained here, measurements of doors, windows, rooms and any other items are approximate and no responsibility is taken for any error, omission or mis-statement. This plan is for illustrative purposes only and should be used as such by any prospective purchaser. The services, systems and appliances shown have not been tested and no guarantee as to their operability or efficiency can be given.  
Made with Metropix ©2022

THE PROPERTY MISDESCRIPTIONS ACT 1991. The agent has not tested any apparatus, equipment, fixtures or services and so cannot verify that they are in working order, or fit for the purpose. References to the Tenure of a property are based on information supplied by the vendor. The agent has not had sight of the Title documents. A buyer is advised to obtain verification from their Solicitor or Surveyor. Note: These details are correct at time of going to press.

25 Silver Street, Enfield Town, Middlesex,  
EN1 3EF  
T: 0208 364 4118  
E:  
www.kings-group.net

