



**Flat 88, 3, Cannock Court
Hawker Place,
Walthamstow**

**Offers In The Region
Of £375,000
Leasehold**



Flat 88, 3, Cannock Court Hawker Place, Walthamstow

248 Hoe Street, Walthamstow, London,
E17 3AX

020 8521 1122
www.kings-group.net

- Chain Free
- Close Proximity to Wood Street Station
- Two Double Bedrooms
- Balcony
- Open Planned Living Space
- En-Suit To Master Bedroom

Tenure & Council Tax

Tenure: Leasehold
Lease length: 135 Years Remaining
Service Charge: £2,198 P/A
Ground Rent:£240 P/A
Council Tax Band: C
Annual Council Tax Estimate: £2025

Hallway 12'11" x 17'10" (3.96 x 5.46)

Lounge/Diner 9'10" x 21'3" (3.00 x 6.50)

Kitchen 7'6" x 9'2" (2.30 x 2.80)

Bathroom 6'2" x 6'10" (1.90 x 2.10)

Bedroom One 8'6" x 17'0" (2.60 x 5.20)

En Suite 5'6" x 7'2" (1.70 x 2.20)

Bedroom Two 9'2" x 12'5" (2.80 x 3.80)

Balcony 4'1" x 9'10" (1.25 x 3.00)

Welcome to this charming purpose-built flat located on Hawker Place in the vibrant city of London. This delightful property boasts a generous 667 square feet of living space, providing ample room for comfortable living. Built in 2007, the flat is modern and well-maintained, making it an ideal choice for those seeking a contemporary home.

As you enter, you will find a spacious reception room that serves as the heart of the home, perfect for relaxation or entertaining guests. The flat features two double bedrooms, offering plenty of space for rest and privacy. The layout is thoughtfully designed to maximise natural light, creating a warm and inviting atmosphere throughout.

One of the standout features of this property is its convenient location. It is within walking distance to Wood Street Station, making commuting a breeze. Additionally, you will find a variety of local shops and amenities just a short stroll away, ensuring that all your daily needs are easily met.

For those who enjoy an active lifestyle, the flat also includes access to a residents-only gym, providing a fantastic opportunity to stay fit without having to leave the comfort of your home.

This property is chain-free, allowing for a smooth and straightforward purchasing process. Whether you are a first-time buyer, a young professional, or looking to invest, this flat offers a wonderful opportunity to enjoy city living at its finest. Do not miss the chance to make this lovely flat your new home.

FIRST FLOOR
74.6 sq.m. (803 sq.ft.) approx.

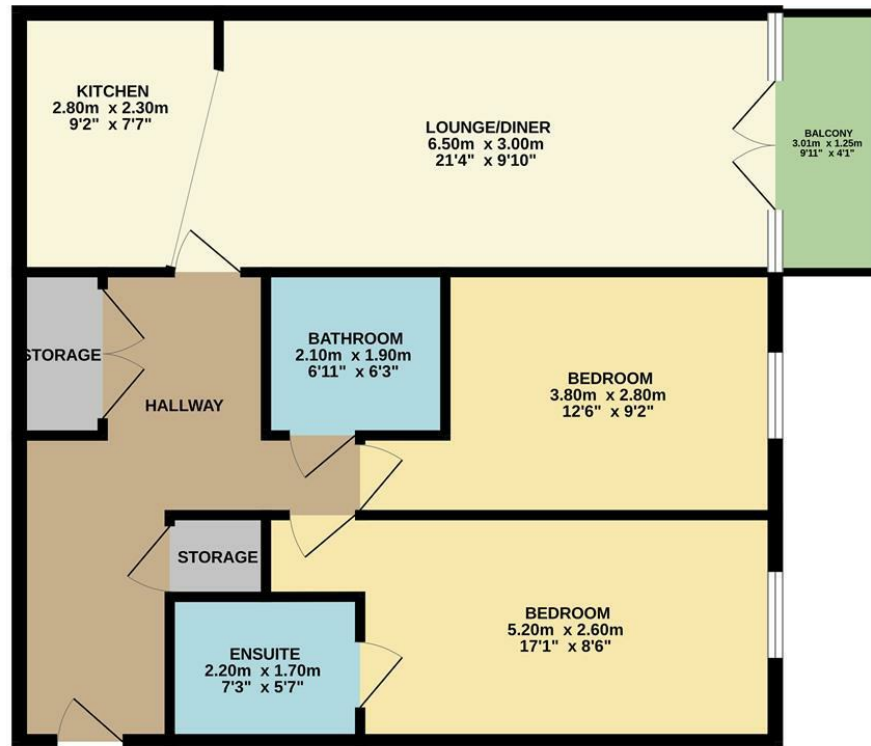

TOTAL FLOOR AREA : 65.0 sq.m. (700 sq.ft.) approx.
Whilst every attempt has been made to ensure the accuracy of the floorplan contained here, measurements of doors, windows, rooms and any other items are approximate and no responsibility is taken for any error, omission or mis-statement. This plan is for illustrative purposes only and should be used as such by any prospective purchaser. The services, systems and appliances shown have not been tested and no guarantee as to their operability or efficiency can be given.
Made with Metropix ©2025



THE PROPERTY MISDESCRIPTIONS ACT 1991. The agent has not tested any apparatus, equipment, fixtures or services and so cannot verify that they are in working order, or fit for the purpose. References to the Tenure of a property are based on information supplied by the vendor. The agent has not had sight of the Title documents. A buyer is advised to obtain verification from their Solicitor or Surveyor

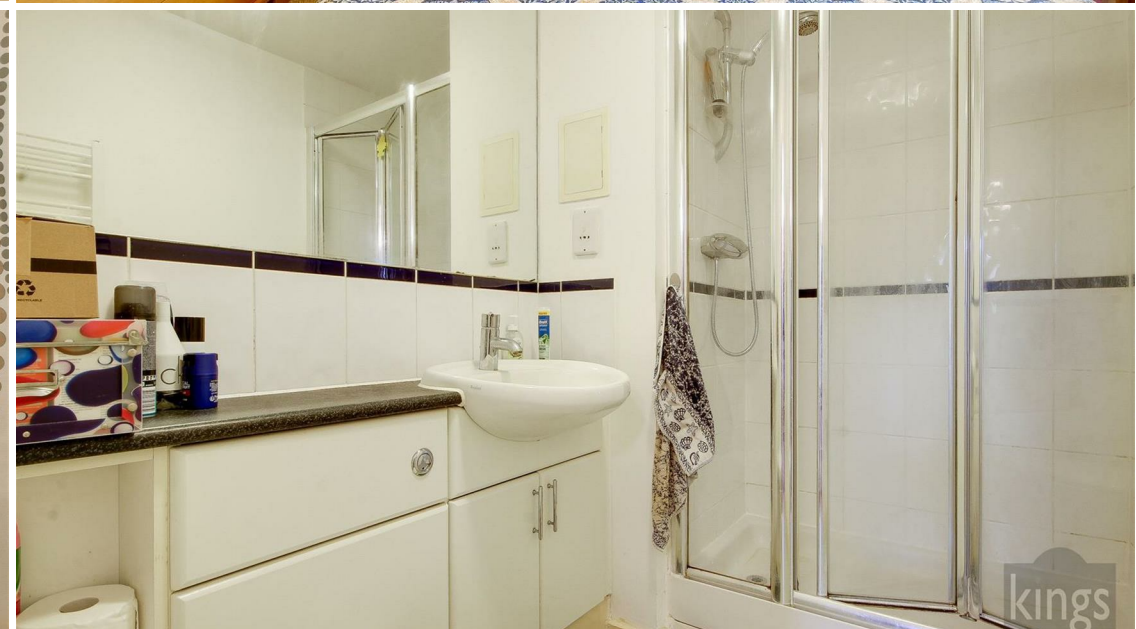

248 Hoe Street, Walthamstow, London,
E17 3AX

020 8521 1122
www.kings-group.net



Zoopa.co.uk



rightmove.co.uk
The UK's number one property website

