



www.kings-group.net

248 Hoe Street
Walthamstow E17 3AX
Tel: 020 8521 1122

Cairo Road, London, E17 3AE
£210,000

Nestled on the charming Cairo Road in London, this delightful house offers a perfect blend of comfort and convenience. With a total area of 592 square feet, the property features one well-proportioned reception room, ideal for relaxation or entertaining guests. The single bedroom provides a peaceful retreat, while the bathroom is designed for both functionality and comfort.

This residence is part of an over 60's development, making it an excellent choice for those seeking a community-oriented environment. The property is chain-free, allowing for a smooth and straightforward purchasing process.

Situated within walking distance to Walthamstow Central, residents will enjoy easy access to a variety of shops, cafes, and local amenities, enhancing the overall living experience. Additionally, the availability of parking adds to the convenience of this lovely home.

Whether you are looking to downsize or seeking a tranquil place to call home, this property on Cairo Road presents an excellent opportunity to enjoy a comfortable lifestyle in a vibrant area of London.



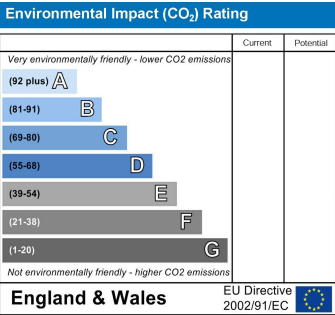
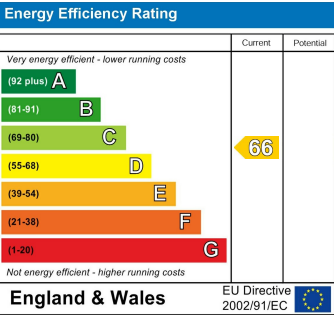





kings
GROUP

GROUND FLOOR
43.6 sq.m. (470 sq.ft.) approx.

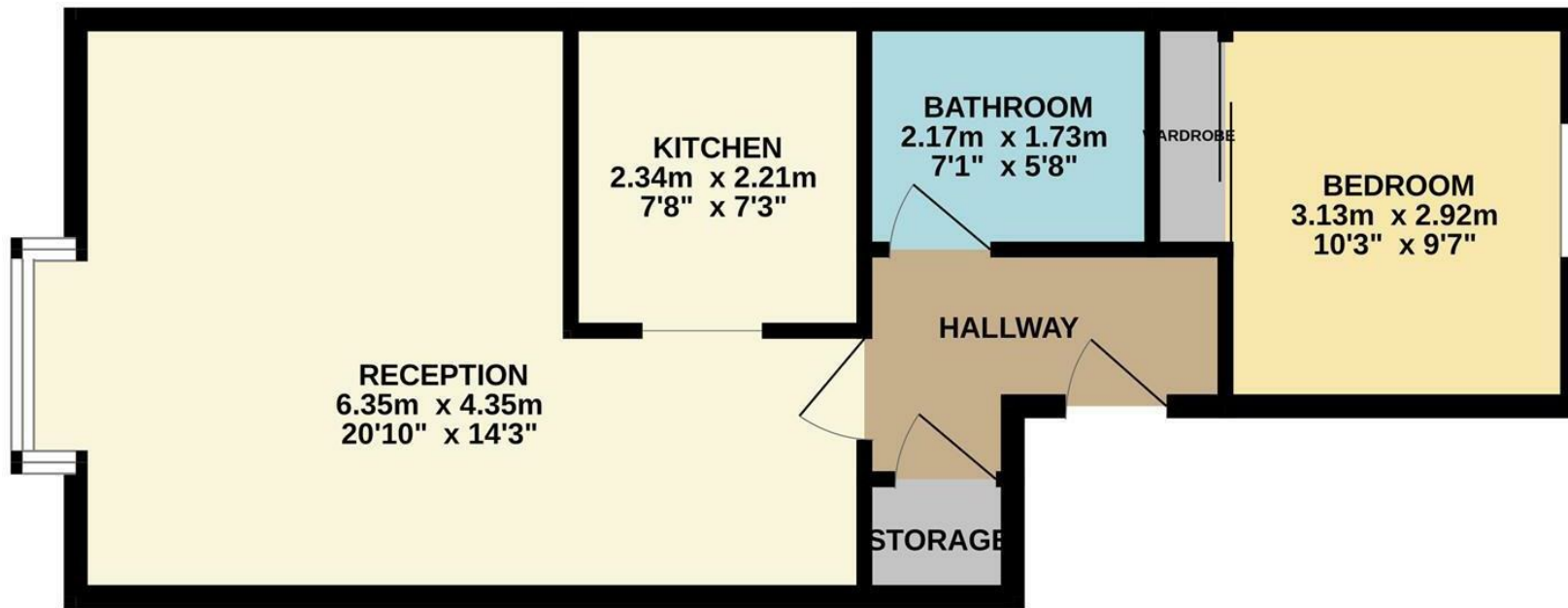

TOTAL FLOOR AREA : 43.6 sq.m. (470 sq.ft.) approx.

Whilst every attempt has been made to ensure the accuracy of the floorplan contained here, measurements of doors, windows, rooms and any other items are approximate and no responsibility is taken for any error, omission or mis-statement. This plan is for illustrative purposes only and should be used as such by any prospective purchaser. The services, systems and appliances shown have not been tested and no guarantee as to their operability or efficiency can be given.
Made with Metropix ©2024



Associated Offices in London, Essex and Hertfordshire
Kings Head Office Tudor Lodge, Burton Lane, Goffs Oak, Hertfordshire EN7 6SY Tel: 01707-872000

