



Windrush, Highworth, SN6 7ED

£225,000  
(Subject to Contract)

*Hanley's*



## Windrush Highworth SN6 7ED

A three bedroom semi detached property set in a elevated position within a short walk of local amenities including schools and doctors surgery. The accommodation requires updating and comprises: Porch, entrance hall, living room, dining room and kitchen with door opening to the rear garden. To the first floor: landing, three bedrooms; two with fitted wardrobes and bathroom with shower over the bath. The property further benefits from gas radiator central heating and double glazing. Outside to the front is a garden laid to lawn and gated access to the side leading to the rear southerly facing garden with patio area and steps up to a garden with lawn and pathway to the rear with gated access. A single garage is located in a nearby block. The property is offered for sale with **NO ONWARD CHAIN**.



**1 Bathroom**



**3 Bedrooms**



**2 Receptions**

**EPC: D57**

**Council Tax Band: B**

**Tenure: Freehold**



**DISCLAIMER.** These particulars, whilst believed to be accurate are set out as a general outline for guidance and do not constitute any part of an offer or contract. Intending purchasers should not rely on them as statements or representation of fact, but must satisfy themselves by inspection or otherwise as to their accuracy. No person in this firm's employment has the authority to make or give any representation or warranty in respect of the property. Floor plan measurements and distances are approximate only. We have not carried out a detailed survey nor tested the services, appliances or specific fittings. Your home is at risk if you do not keep up repayments on a mortgage or other loan secured on it.



GROUND FLOOR  
357 sq.ft. (33.1 sq.m.) approx.

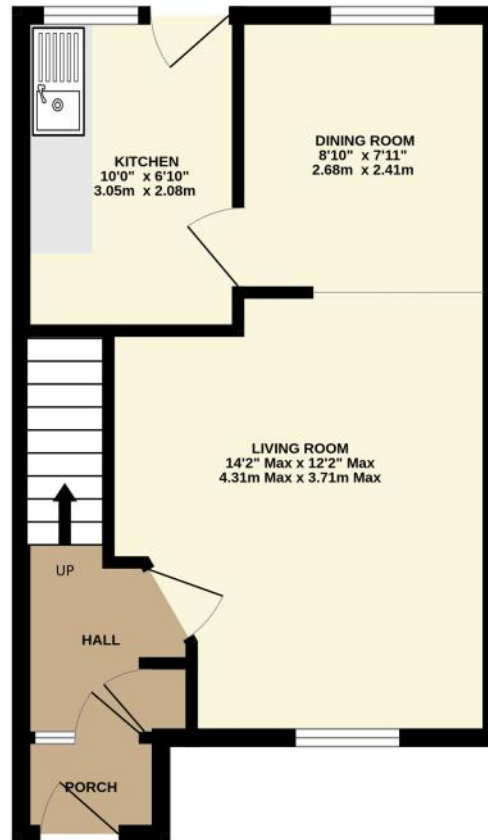

1ST FLOOR  
343 sq.ft. (31.9 sq.m.) approx.

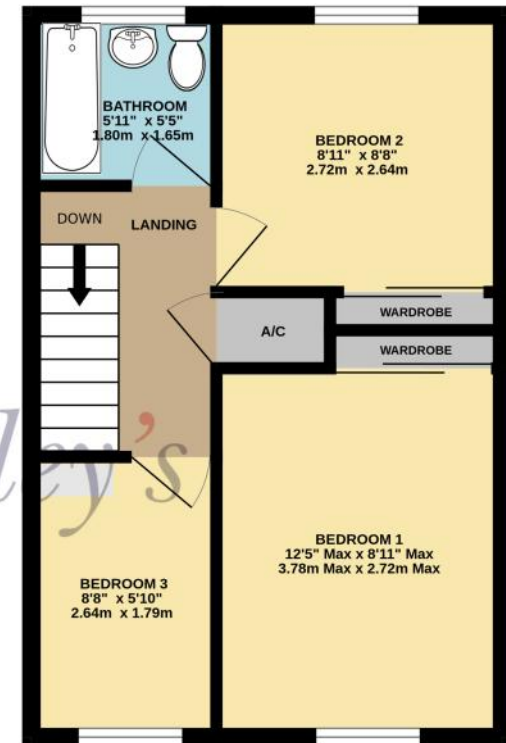

TOTAL FLOOR AREA : 700 sq.ft. (65.0 sq.m.) approx.

Whilst every attempt has been made to ensure the accuracy of the floorplan contained here, measurements of doors, windows, rooms and any other items are approximate and no responsibility is taken for any error, omission or mis-statement. This plan is for illustrative purposes only and should be used as such by any prospective purchaser. The services, systems and appliances shown have not been tested and no guarantee as to their operability or efficiency can be given.

Made with Metropix ©2025



