



Sinclair

11 Albert Terrace, Off High Street, Loughborough, Leicestershire, LE11  
2DE

£750

01509 600610 [sinclairestateagents.co.uk](http://sinclairestateagents.co.uk)

## Property at a glance

- Two Bedrooms
- Modern Interior
- Available mid June
- Council Tax Band\*: B
- Ground Floor Apartment
- Town Centre Location
- No parking available
- Price: £750

## Overview

**\*TWO BEDROOM MODERN TOWN CENTRE APARTMENT\*** - Situated within the centre of Loughborough, this two bedroom ground floor apartment has newly finished accommodation comprising entrance hall, open plan living space with fitted kitchen, two bedrooms with wardrobes/ cupboards and a shower room with generously proportioned walk in shower. Available mid June. contact us now to arrange a viewing ! Please note there is no parking on site or nearby.

## Location\*\*



\*\* Distances have been taken from Google maps and are shown as shortest distance by road. These should be taken as approximate figures.

## Ground Floor

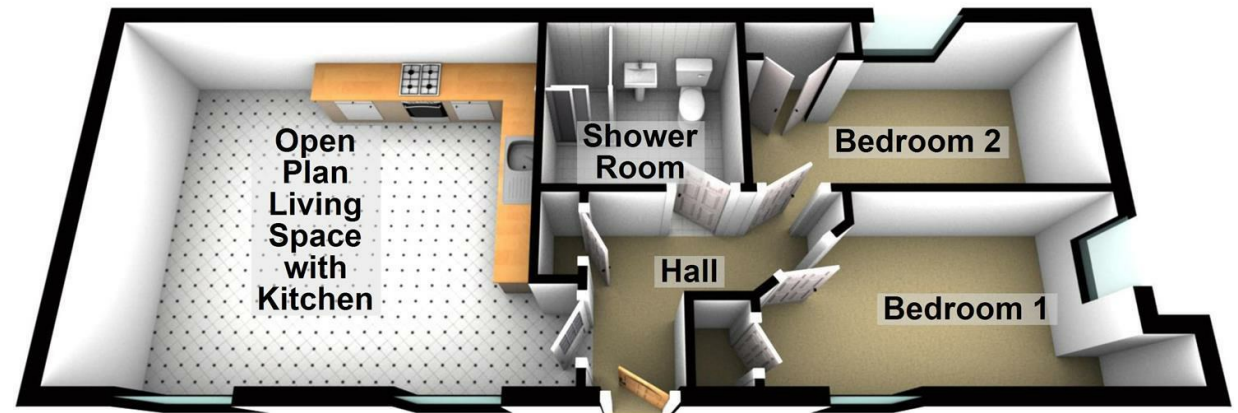

11 Albert Terrace, Off High Street, Loughborough, Leicestershire, LE11 2DE

Sinclair

## Detailed Accommodation

11 Albert Terrace, Off High Street, Loughborough, Leicestershire, LE11 2DE

**Sinclair**



11 Albert Terrace, Off High Street, Loughborough, Leicestershire, LE11 2DE

Sinclair



11 Albert Terrace, Off High Street, Loughborough, Leicestershire, LE11 2DE

Sinclair

11 Albert Terrace, Off High Street, Loughborough, Leicestershire, LE11 2DE

**Sinclair**

11 Albert Terrace, Off High Street, Loughborough, Leicestershire, LE11 2DE

Sinclair

11 Albert Terrace, Off High Street, Loughborough, Leicestershire, LE11 2DE

Sinclair



## Energy Efficiency Rating

	Current	Potential
<i>Very energy efficient - lower running costs</i>		
(92 plus) <b>A</b>		
(81-91) <b>B</b>		
(69-80) <b>C</b>		
(55-68) <b>D</b>		
(39-54) <b>E</b>		
(21-38) <b>F</b>		
(1-20) <b>G</b>		
<i>Not energy efficient - higher running costs</i>		
<b>England &amp; Wales</b>	EU Directive 2002/91/EC	

These particulars do not constitute any part of an offer or contract and although every effort is made to make them accurate, should not be relied upon as statements or representations of fact. Neither the vendor nor Sinclair has any authority to make or give any warranty whatsoever in relation to this property. Intending purchasers must satisfy themselves of the accuracy of all measurements and the function of all appliances and installations

### Fixture & Fittings

All fixtures and fittings as mentioned in the "For Sale" Particulars are included in the sale price.

### Special Note To Buyers

Sinclair Estate Agents have not tested any of the services or installations mentioned in these "For Sale" particulars and cannot provide any guarantee or warranty of their condition. Interested parties should make investigations to confirm the existence/condition of such services/installations to their own satisfaction.

\* Council Tax Band correct at the time of instruction. Taken from Directgov.uk

\*\* All distances have been taken from Google maps and must be taken as approximate.

### Photographs

Photographs are reproduced for general information and it must not be inferred that any item is included for sale with the property.

### Money Laundering

Under the protecting Against Money Laundering and then Proceeds of Crime Act 2002, we must point out that any successful purchasers who are proceeding with a purchase will be asked for identification i.e passport, driving licence etc and also for proof of current address i.e recent bill or bank statement. This evidence will be required prior to solicitors being instructed in the purchase or sale of a property.

### Tenure

We are advised by the vendor(s) that the premises are

# Sinclair

## Thinking of Selling?

For a free valuation of your property with no obligation  
call Sinclair on 01509 600610



Sinclair Estate Agents Ltd Registered Office: Eltham House, 6 Forest Road, Loughborough, Leicestershire. LE11 3NP.  
Registration Number: 5459388. Sinclair Estate Agents are members of the TPO scheme and subscribe to the TPO code of practice.

**Sinclair**

9 Bullring, Shepshed, Leicestershire, LE12 9PX

Tel: 01509 600610

Email: [shepshed@sinclairstateagents.co.uk](mailto:shepshed@sinclairstateagents.co.uk)