





Steep Marsh is a beautiful rural hamlet to the north east of Petersfield yet within just 5 minutes drive of the town centre and mainline railway station. The A3 is just a few moments drive but not with the noise that is normally associated with it! Located in stunning open countryside with far reaching views. Bedales School is also just a short drive away. Charming countryside walks on all sides.

'Marshlands' is a 1970's architect designed house that has been extended by the current owner to now offer a very large detached family home with flexible ground floor accommodation situated in a plot of 1/3 of an acre, with sweeping views to the rear.

The house is sold with no forward chain.

Accommodation comprises of;

Large external covered porch giving access to internal hallway.

To the right is a pretty Snug Room with open fireplace.

The inner hallway gives access to the first floor with a solid wood open tread staircase.

Kitchen/breakfast room with space for dining table and chairs. Electric oven and hob, integrated fridge, freezer and dishwasher.

Utility room with space for tumble drier and washing machine. WC and hand basin.

Study with built in cupboard and sliding patio doors to rear



garden.

Large Sitting Room which gives access via double doors to a Dining Room with French doors to a lovely enclosed and pretty front garden.

The Conservatory is of excellent size and leads to the rear terrace via French doors.

On the first is a Principal bedroom suite with built in wardrobes and three piece ensuite shower room and there are three further good size bedrooms, all with built in wardrobes.

Family bathroom with shower over the bath.

To the front is a charming front garden and lawn which is totally private and hedged.

Driveway parking for several vehicles that leads to the detached single garage.

The rear of the house has a full width terrace that leads to a very large lawn with beautifully appointed shrub and plant borders which, in turn, leads to an orchard with many fruit trees. Large garden shed. Stunning open countryside views.

No onward chain!

Oil central heating. Mains water, drainage and electricity.

Double glazed windows.

Council Tax Band F - £3223 per annum.



For further information, please contact Jacobs & Hunt Estate Agents, Petersfield.



Steep Marsh, Petersfield

Approximate Gross Internal Area = 167.6 sq m / 1804 sq ft

Outbuildings = 22.8 sq m / 245 sq ft

Total = 190.4 sq m / 2049 sq ft

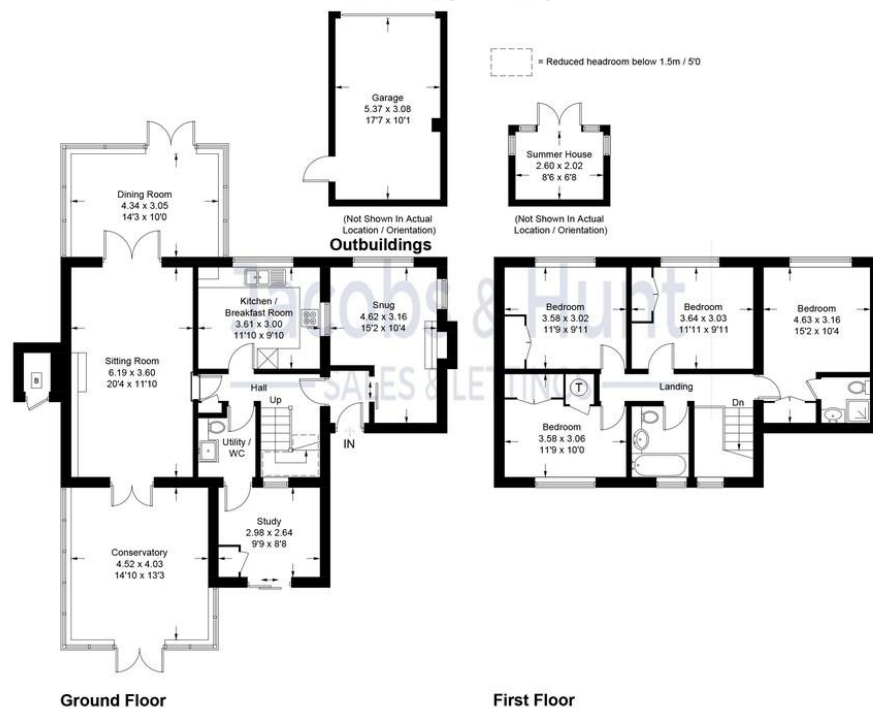

Illustration for identification purposes only,
measurements are approximate, not to scale. (ID1203605)



Score	Energy rating	Current	Potential
92+	A		
81-91	B		
69-80	C		72 C
55-68	D		
39-54	E	50 E	
21-38	F		

26 Lavant Street, Petersfield,
Hampshire, GU32 3EF

www.jacobshunt.co.uk
01730 262744
properties@jacobshunt.co.uk

Agents Note: Whilst every care has been taken to prepare these particulars, they are for guidance purposes only. All measurements are approximate and are for general guidance purposes only and whilst every care has been taken to ensure their accuracy, they should not be relied upon and potential buyers/tenants are advised to recheck the measurements



Zoopla rightmove onTheMarket