

HENSINGTON ROAD  
WOODSTOCK  
OXFORDSHIRE

# 43 Hensington Road, Woodstock

Oxfordshire, OX20 1JH

This well-proportioned three-bedroom Victorian home unfolds over nearly 1300 Sq Ft across three floors. The property is set back from the road and sits in an attractive terrace, characterised by its brick fronted façade, and just a short walk from the centre of Woodstock and its plethora of shops, pubs, restaurants and cafes.

Approached via a gated front garden, once inside there is an entrance hallway that leads to a large double reception room with feature fireplace and box bay window. The 'L' shaped kitchen/dining room is positioned at the rear of the plan, adjacent to a light-filled conservatory that opens to the private rear garden.

On the first floor there are two bedrooms and a large family bathroom. The loft room occupies the second floor, with an exposed brick feature wall, Velux skylights and eaves storage.

Externally, the front garden is paved with mature hedging, there is a private rear garden mainly laid to lawn with rear gated access from Green Lane. The property offers potential to extend and a reconfigure subject to the usual consent.

**Guide Price: £500,000**

 3

 1

 1



South West Facing









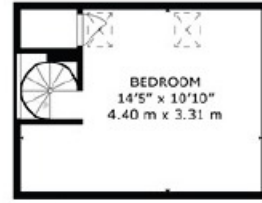
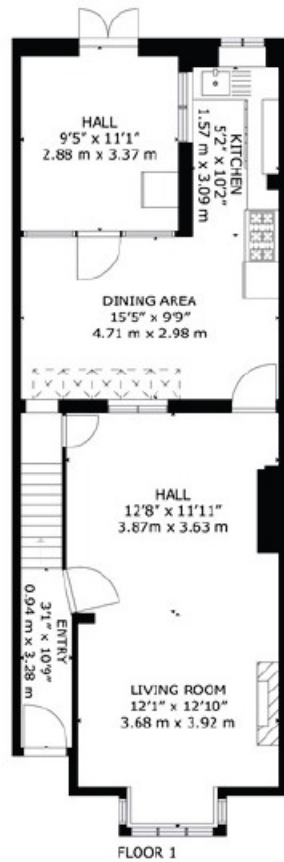

FLOOR 3



FLOOR 2

GROSS INTERNAL AREA  
 FLOOR 1: 731 sq.ft, 68 m<sup>2</sup>, FLOOR 2: 363 sq.ft, 34 m<sup>2</sup>, FLOOR 3: 162 sq.ft, 15 m<sup>2</sup>  
 TOTAL: 1256 sq.ft, 117 m<sup>2</sup>  
 SIZES AND DIMENSIONS ARE APPROXIMATE, ACTUAL MAY VARY.

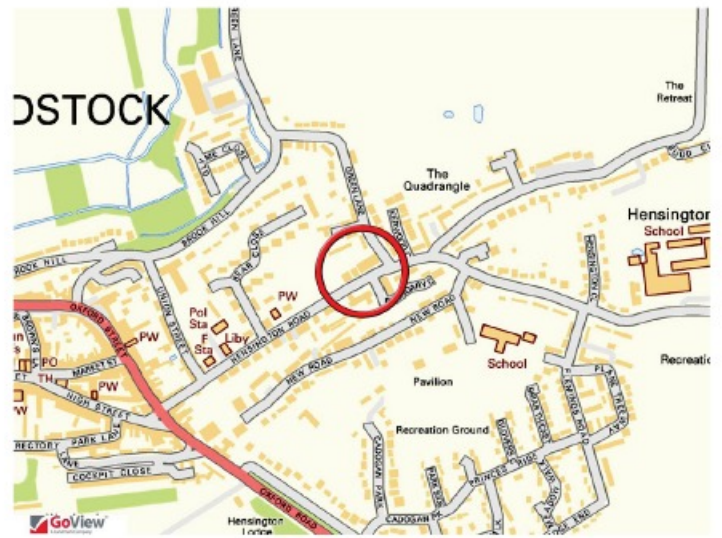

**Council Tax:**  
C

**Parking**  
On street parking nearby

**Local Authority**  
West Oxfordshire District Council

43 HENSINGTON ROAD  
WOODSTOCK  
OX20 1JH

Energy rating

**D**

Valid until  
**3 March 2031**

Certificate number  
**0523-3004-0207-0829-2200**

IMPORTANT NOTICE: These particulars are for information purposes only and do not in whole or in part constitute or form part of any offer or contract, nor should any statement obtained herein be relied upon as a statement or representation of fact. Breckon & Breckon do not test whether the services connected to the property, heating systems and domestic appliances are in working order. We therefore recommend that the purchaser obtains verification from their surveyor or solicitor. Whilst every attempt has been made to ensure the accuracy of the floor plans contained here, measurements of doors, windows and rooms are approximate and no responsibility is taken for any error, omission or mis-statement. These plans are for representation purposes only as defined by the RICS code of measuring practice and should be used as such by any possible purchaser.



# “Area Description”

*Woodstock is an historic town adjoining one of Britain's finest World Heritage Sites and has shops, hotels and restaurants, cafes and public houses and a vibrant community. There are Churches of several denominations, a museum, open air swimming pool, and a tennis and bowling club. There is a well regarded Primary School, a regular bus services to Oxford and local market towns of Chipping Norton and Witney. Rail to Oxford and London from nearby Long Hanborough and Oxford Parkway.*





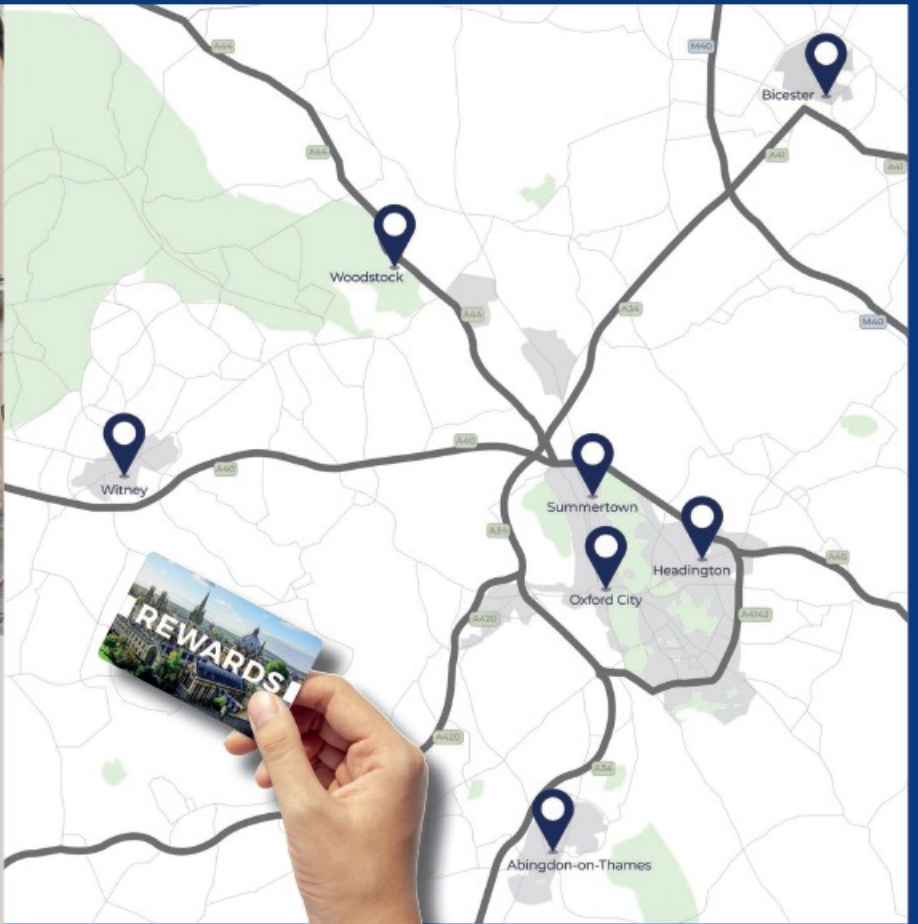

## Our network of offices across Oxfordshire

Every office has access to every buyer registered across our network of seven offices.

Sharing a single database of buyers ensures maximum exposure for our clients.

### Woodstock Sales

34 High Street  
Woodstock  
Oxfordshire  
OX20 1TG

t: 01993 811881  
e: woodstock@breckon.co.uk



**FROM LEFT:**  
Martyn Brittain, Phoebe Southgate,  
Cheryl Pearson, Jack Smith

**BRECKON REWARDS**  
Scan to find out more!



**naea**  
**propertymark**  
**PROTECTED**

**Summertown**  
t: 01865 310300 (sales)  
t: 01865 201111 (letting)  
e: summertown@breckon.co.uk

**Oxford City Centre**  
t: 01865 244735 (sales)  
t: 01865 201111 (letting)  
e: post@breckon.co.uk

**Headington**  
t: 01865 750200 (sales)  
t: 01865 763999 (letting)  
e: headington@breckon.co.uk

**Abingdon-on-Thames**  
t: 01235 550550 (sales)  
t: 01235 554040 (letting)  
e: abingdon@breckon.co.uk

**Witney**  
t: 01993 776775 (sales)  
t: 01993 899972 (letting)  
e: witney@breckon.co.uk

**Bicester**  
t: 01869 242423 (sales & letting)  
e: bicester@breckon.co.uk

**New Homes**  
t: 01865 261222  
e: newhomes@breckon.co.uk

**Land Team**  
t: 01865 558999  
e: land@breckon.co.uk

**Letting and Property Management**  
t: 01865 201111  
e: lettings@breckon.co.uk

**Creative Department**  
t: 01865 310300  
e: creative@breckon.co.uk

**Breckon & Breckon**  
est. 1947