



Thornford Drive, Westlea, Swindon

OIRO £199,995



 2  1  0

Freehold | EPC rating: C

- No onward chain
- West Swindon location
- Allocated parking

BELVOIR!

Property is personal

Email
swindon@belvoir.co.uk

Phone
01793 542060

Description

Offered for sale with NO ONWARD CHAIN is this two-bedroom terrace house with allocated parking ideal for first time buyers or investors. The property is located within the popular Westlea development of West Swindon and within walking distance to schools, local amenities, shops, Shaw Ridge Lesiure centre and with great transport links to the town centre and M4.

The accommodation comprises of kitchen, sitting/dining room, two double bedrooms and a modern bathroom.

Externally there is a front garden laid to lawn while to the rear a good sized fully enclosed garden with patio area.

In addition the property benefits from UPVC double glazed windows, gas central heating and an allocated parking space.

These particulars are issued in good faith but do not constitute representations of fact or form part of any offer or contract. The matters referred to in these particulars should be independently verified by prospective buyers or tenants. Neither Belvoir nor any of its employees or agents has any authority to make or give any representation or warranty whatever in relation to this property. FLOOR PLANS - The floorplans are intended as a guide only. This is NOT TO SCALE and dimensions are approximate. These particulars have been prepared for the guidance of intending purchasers but no guarantee of their accuracy is given, neither do they form a contract of any part thereof.

Photographs



Floorplan

Ground Floor

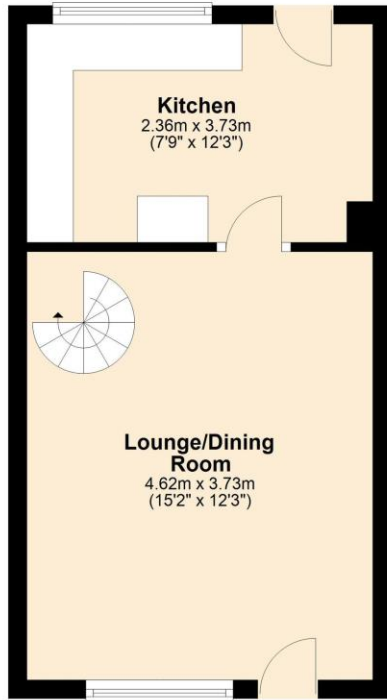

First Floor

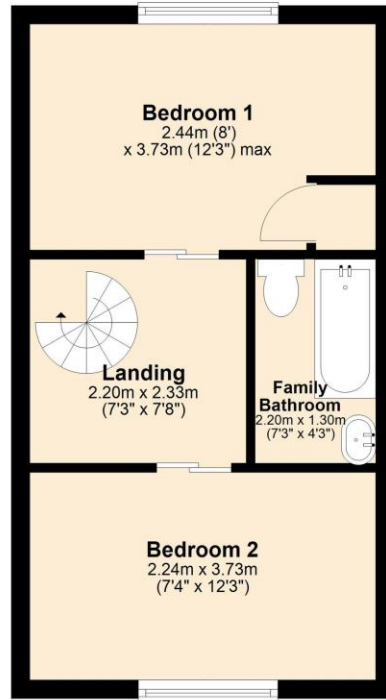

Map

