





Step inside and be captivated by this beautifully presented three-bedroom detached home, perfectly positioned on a generous plot with open fields stretching beyond the large rear garden. Set back from the road, the property boasts a spacious driveway and offers flowing, light-filled accommodation throughout. Enjoy serene garden views from both the sitting and dining rooms, while a versatile conservatory provides a peaceful retreat. The thoughtfully designed kitchen and convenient cloakroom enhance everyday living. Upstairs, three generously sized bedrooms and a modern shower room complete the layout. Ideal for those seeking ample outdoor space in a quiet, semi-rural location.

Entrance Hall

8' 6" x 4' 5" (2.60m x 1.35m)

Welcome entrance hall with stairs leading to first floor accommodation. Radiator.

Cloakroom

6' 9" x 4' 10" (2.07m x 1.47m)

WC and pedestal wash basin. Storage cupboard and window to front. Radiator

Kitchen

11' 3" x 7' 11" (3.43m x 2.41m)

Well designed with ample wall and base cupboard and drawer units with wood worktops over. Inset sink and drainer. Electric oven with hob and extractor fan over. Space for a full fridge freezer and washing machine. Window to front and radiator.

Sitting Room

19' 6" x 13' 3" (5.95m x 4.03m)

Spacious room with an inset log burner and brick surround. French doors leading to the conservatory. Window to rear and radiator.

Conservatory

12' 5" x 7' 6" (3.78m x 2.28m)

French doors lead to the garden. Heated towel rail.

Dining/Family Room

17' 3" x 9' 11" (5.27m x 3.03m)

Well proportioned dual aspect room with radiator.

Landing

11' 3" x 8' 1" (3.44m x 2.46m)

Bright airy space. Window and loft access. Radiator

Bedroom 1

11' 3" x 8' 2" (3.44m x 2.48m)

Generous size double room with window and radiator

Bedroom 2

11' 7" x 8' 0" (3.54m x 2.44m)

Double room with window and radiator

Bedroom 3

9' 10" x 8' 0" (3.00m x 2.44m)

Good size room with window and radiator

Shower Room

9' 10" x 8' 0" (3.00m x 2.44m)

WC and pedestal wash basin. Separate shower cubicle with shower head over. Airing cupboard. Window and radiator.

Outside

Front Garden

Blocked paved driveway offering ample parking. Lawn area. Access to the rear garden.

Rear Garden

A large well maintained south facing garden laid mainly to lawn with patio seating area enclosed by a picket fence. Enclosed by fencing and hedging with field views to the rear boundary. Timber garden shed and wildlife pond.

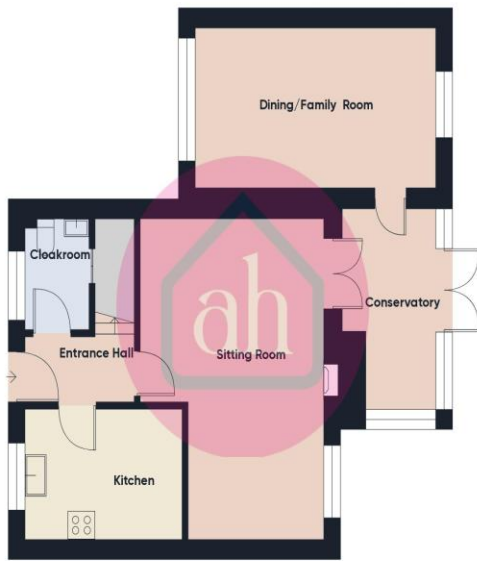

Ground Floor



Floor 1

Approximate total area⁽¹⁾
1045.17 ft²

(1) Excluding balconies and terraces

While every attempt has been made to ensure accuracy, all measurements are approximate, not to scale. This floor plan is for illustrative purposes only.

Calculations are based on RICS IPMS 3C standard.

GIRAFFE360

Consumer Protection from Unfair Trading Regulations 2008 We have not tested any apparatus, equipment, fixtures, fittings or services and so cannot verify that they are in working order or fit for purpose. You are advised to obtain verification from your solicitor or surveyor. References to the tenure of a property are based on information supplied by the seller. We have not had sight of the title documents and a buyer is advised to obtain verification from their solicitor. Items shown in photographs are not included unless specifically mentioned within the sales particulars, but may be available by separate negotiation. We advise you to book an appointment to view before embarking on any journey to see a property, and check its availability.