



Hunters Moon Forge Lane, High Halstow, ME3 8SL

Virtual Tour Available. Be the first to view this fantastic project in one of High Halstow's most prestigious roads, in a semi-rural country setting.

This two-storey CHAIN FREE home boasts an impressive total area of 1851.39 square feet. The ground floor is thoughtfully designed with a fully fitted kitchen and a comfortable living room. An additional room on the ground floor can function as a dining room or a home office according to the prospective homeowner's preference, a sunroom, perfect for enjoying leisurely mornings, rounds up the ample living space. A convenient WC, a shower room, a double bedroom and an attached garage complete the ground floor. The first floor offers another two double bedrooms and a third room which could be a study or cot room, as well as a WC, making this house a perfect setting for comfort and functionality. Overall, this adaptable property with a total of three bedrooms and two bath/shower rooms offers versatile residential options to cater to all your lifestyle needs.

High Halstow is a village and civil parish on the Hoo Peninsula in the unitary authority of Medway. There are many amenities within close proximity including schools, shops, a church, medical practice and much more.

Call us now to book your internal viewing!
COUNCIL TAX BAND E. EPC E.

- NO CHAIN
- DRIVE
- GARAGE
- LARGE PLOT
- FAR REACHING VIEWS
- COUNCIL TAX BAND E
- 3 DOUBLE BEDROOMS
- UPSTAIRS STUDY/COT ROOM
- UTILITY

£575,000



Ground Floor

Approximate total area^m
 1851.47 ft²
 172.01 m²

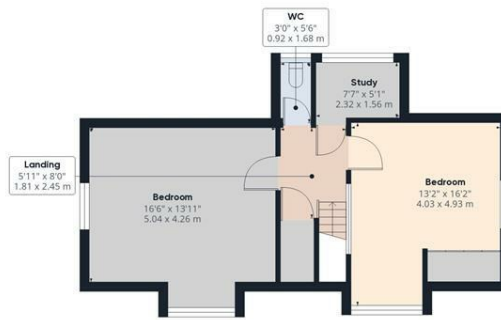

Floor 1

Excluding balconies and terraces

While every attempt has been made to ensure accuracy, all measurements are approximate, not to scale. This floor plan is for illustrative purposes only.

GIRAFFE 360

