



The Spinney, Marsh Road, North Wootton PE30 3QJ

£699,995

 6  4  5



ESCAPE TO THE COUNTRY! Whether it's the morning mist on a frosty winter's day or the stunning summer sunsets across the Norfolk countryside, you'll never get tired of the breath taking views this home is surrounded by. A simply wonderful home from where to create a lifetime of memories.





Key Features

- Stunning Detached Home
- Ideal for Multi-Generational Living
- Fabulous Home and Potential Holiday Let
- Escape to the Country
- Different Views and Aspects from Every Room
- Six Bedrooms
- Idyllic Rural Setting - surrounded by Paddocks and Countryside
- Beautiful Gardens
- Over 1/2 an Acre Plot (STMS)
- Superb Level of Flexible Accommodation

GROUND FLOOR
2208 sq.ft. (205.2 sq.m.) approx.

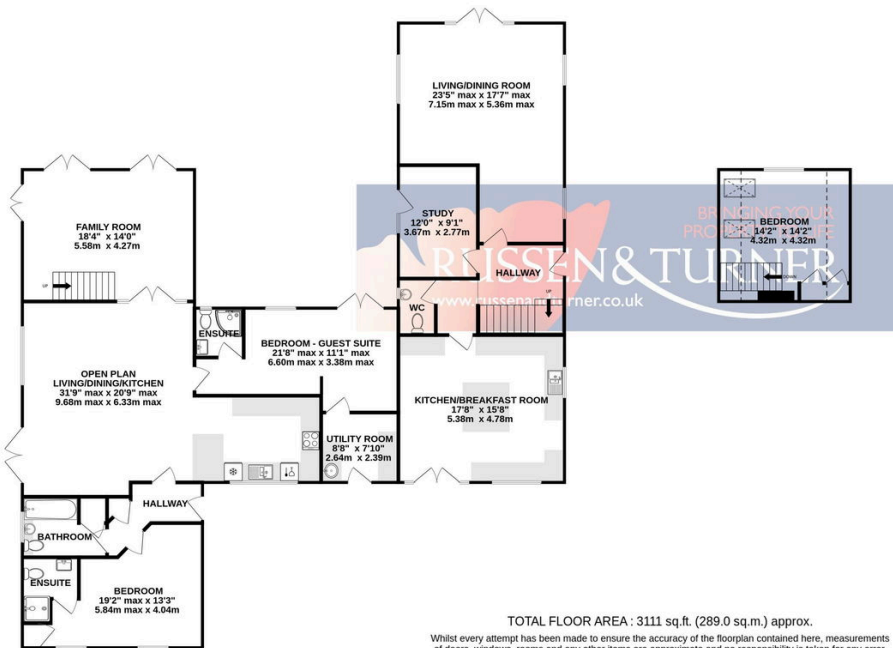

1ST FLOOR
903 sq.ft. (83.9 sq.m.) approx.



TOTAL FLOOR AREA : 3111 sq.ft. (289.0 sq.m.) approx.

Whilst every attempt has been made to ensure the accuracy of the floorplan contained here, measurements of doors, windows, rooms and any other items are approximate and no responsibility is taken for any error, omission or mis-statement. This plan is for illustrative purposes only and should be used as such by any prospective purchaser. The services, systems and appliances shown have not been tested and no guarantee as to their operability or efficiency can be given.
Made with Metropix ©2024

