





21 Ennerdale Drive, South Wootton PE30 3NZ

£375,000

 3  1  1



In a spot so secluded you could miss it! Tucked away near the bottom of a cul-de-sac, enjoying peace, quiet and tranquillity, this wonderfully proportioned bungalow offers flexible accommodation coupled with a beautifully mature and manicured garden, off-road parking and an attached garage.





Key Features

- Detached Bungalow
- Secluded Spot - Tucked away in a cul-de-sac
- Stunning Private Garden
- Generous 17ft Living Room
- 18ft Main Bedroom with Dressing Area
- Three Double Bedrooms
- Off-road Parking and Garage
- Sought After Location
- Superb 22ft Conservatory
- Spacious 17ft Kitchen/Dining Room

GROUND FLOOR
1214 sq.ft. (112.8 sq.m.) approx.

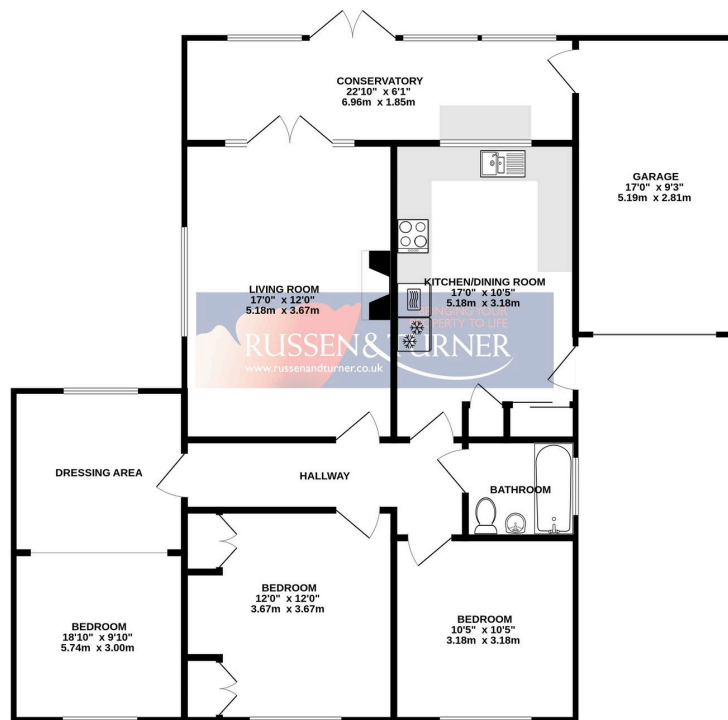

TOTAL FLOOR AREA: 1214 sq.ft. (112.8 sq.m.) approx.

Whilst every attempt has been made to ensure the accuracy of the floorplan contained here, measurements of doors, windows, rooms and any other items are approximate and no responsibility is taken for any error, omission or mis-statement. This plan is for illustrative purposes only and should be used as such by any prospective purchaser. The services, systems and appliances shown have not been tested and no guarantee as to their operability or efficiency can be given.
Made with Metropix ©2024

