



53 Lynn Road, Grimston PE32 1AD

£375,000

3 1 1



COUNTRYSIDE AND CHURCH VIEWS! Backing on to open fields and enjoying distant views of the village church, this generously proportioned, detached bungalow is flooded with natural light. It offers a fantastic level of accommodation, ready for someone to make it their own.





Key Features

- Detached Bungalow
- Stunning Dual Aspect Living Room
- Sought After Location
- Distant View of Church
- Generous Accommodation
- Three Bedrooms
- No Onward Chain
- Rural Setting - Backing on to Open Fields
- Beautiful Gardens
- Garage and Off-road Parking

GROUND FLOOR
1108 sq.ft. (102.9 sq.m.) approx.

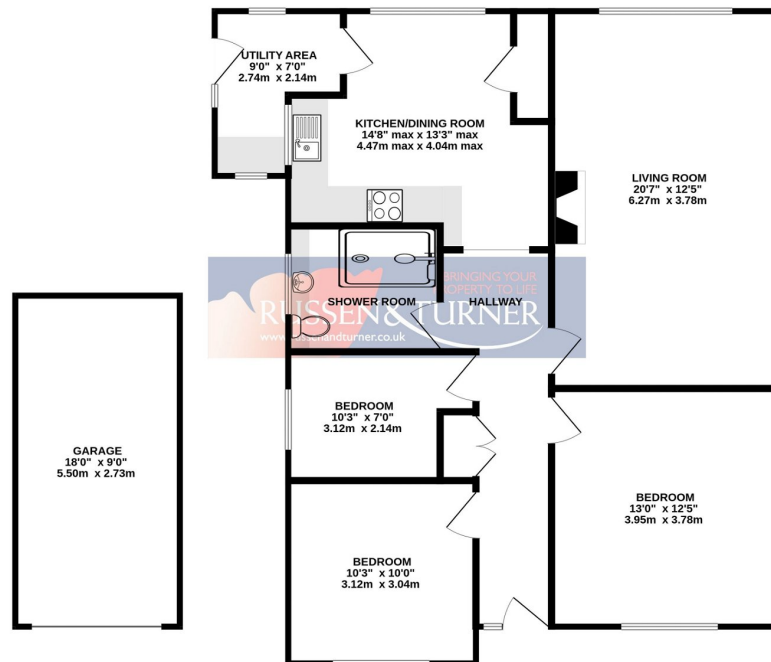

TOTAL FLOOR AREA: 1108 sq.ft. (102.9 sq.m.) approx.

Whilst every attempt has been made to ensure the accuracy of the footprint contained here, measurements of doors, windows, rooms and any other items are approximate and no responsibility is taken for any error, omission or mis-statement. This plan is for illustrative purposes only and should be used to suit by any prospective purchaser. The services, systems and appliances shown have not been tested and no guarantee as to their operability or efficiency can be given.
Made with Metropix ©2024

