



### 3 Foxglove Walk, Wiggenhall St Germans PE34 3FL

£275,000

3 2 1



**NO ONWARD CHAIN!** Country living at it's best. Imagine being able to explore the stunning Norfolk countryside from your doorstep. Set in rural Wiggenhall St Germans this well presented bungalow offers well proportioned, bright and airy accommodation all within walking distance of the village shop, pub and school.





## Key Features

- Detached Bungalow
- Popular Village Location - Close to Village Shop, Pub and School
- Generous Kitchen/Dining Room
- Oil Fired Central Heating
- En-suite Shower Room
- Three Bedrooms
- No Onward Chain
- Garage and Off-road Parking
- Stunning Countryside Walks on your Doorstep
- Conservatory

GROUND FLOOR  
1161 sq.ft. (107.9 sq.m.) approx.

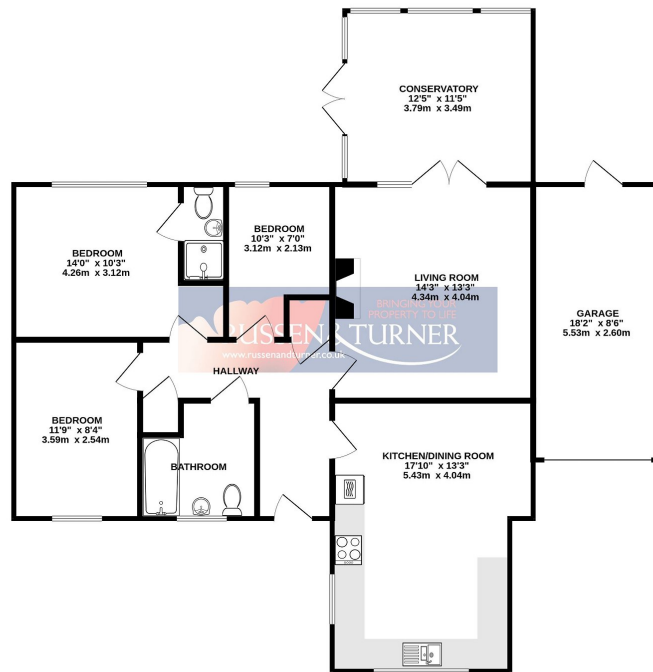

TOTAL FLOOR AREA: 1161 sq.ft. (107.9 sq.m.) approx.  
Whilst every attempt has been made to ensure the accuracy of the floorplan contained herein, measurements of doors, windows, rooms and any other items are approximate and no responsibility is taken for any error, omission or mis-statement. This plan is for illustrative purposes only and should be used as such by any prospective purchaser. The services, systems and appliances shown have not been tested and no guarantee is given as to their capability or efficiency can be given.  
Made with Metropix ©2024

