

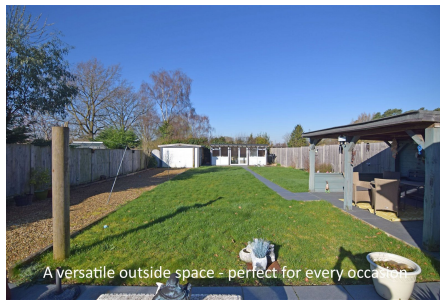

52 West Winch Road, West Winch PE33 0NB

£299,995

 2  1  2



Love entertaining? Want a home that will wow your guests? This two, double bedroom, detached bungalow does exactly that. With a stunning, contemporary finish, this fabulous home is perfect for a summer BBQ with friends on a Saturday before relaxing with your feet up on a Sunday.





Key Features

- Detached Bungalow
- Two Open Plan Reception Rooms
- Superb Presentation - Ready to move straight into
- Perfect Garden for Entertaining
- Gas Central Heating
- Two Double Bedrooms
- Contemporary Kitchen
- Garage
- Abundance of Off-road Parking
- Utility Room and Second W.C.

GROUND FLOOR
1383 sq.ft. (128.5 sq.m.) approx.

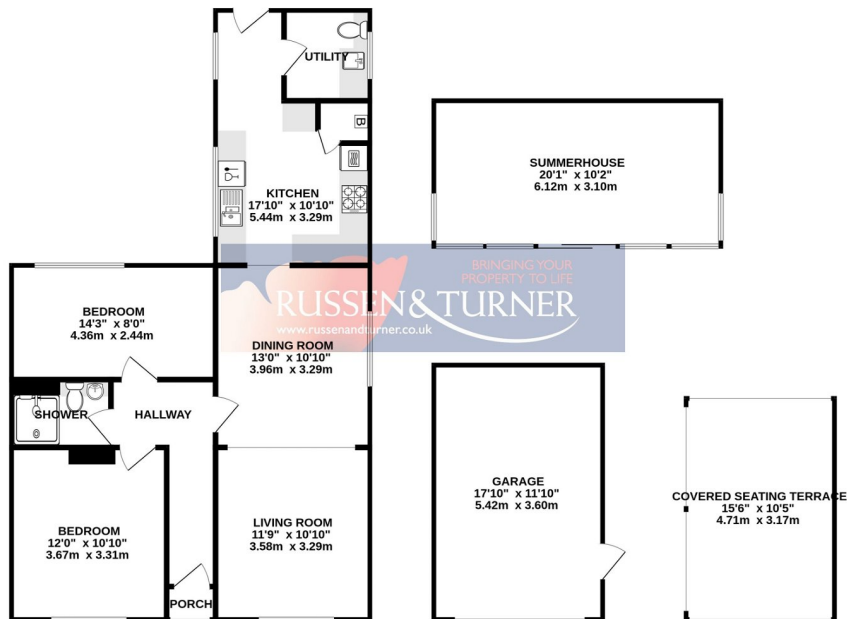

TOTAL FLOOR AREA : 1383 sq.ft. (128.5 sq.m.) approx.

Whilst every attempt has been made to ensure the accuracy of the floorplan contained here, measurements of doors, windows, rooms and any other items are approximate and no responsibility is taken for any error, omission or mis-statement. This plan is for illustrative purposes only and should be used as such by any prospective purchaser. The services, systems and appliances shown have not been tested and no guarantee as to their operability or efficiency can be given.
Made with Metropix ©2024

