

## 11 Baldock Drive, King's Lynn PE30 3DG

£192,000

🛏 2 🚗 1 🛋 1



**Positioned as an exciting opportunity for buyers seeking potential, this well-located bungalow offers the chance to create a home tailored entirely to your own style.** With flexible living space, excellent parking provisions and a manageable outdoor area, it appeals to downsizers, renovators and investors alike. Offered with no onward chain, the property combines immediate practicality with clear scope to enhance and add value, making early viewing strongly recommended to appreciate the possibilities on offer.

## Key Features

- Semi-detached bungalow
- 16ft Lounge
- Car-port
- Double glazed
- Popular location
- 2 Double bedrooms
- Garage
- Gas central heating
- Low-maintenance garden
- Good bus service to town

GROUND FLOOR  
958 sq.ft. (89.0 sq.m.) approx.

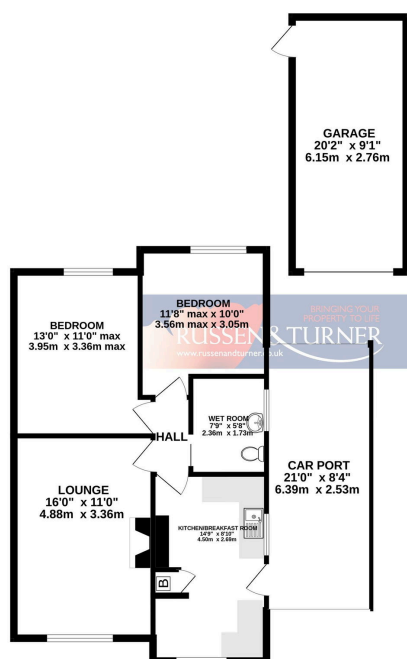

TOTAL FLOOR AREA: 958 sq.ft. (89.0 sq.m.) approx.  
Whilst every attempt has been made to ensure the accuracy of the floorplan contained here, measurements of doors, windows, rooms and any other items are approximate and no responsibility is taken for any error, omission or misstatement. This plan is for illustrative purposes only and should be used as such by any prospective purchaser. The services, systems and appliances shown have not been tested and no guarantee as to their operability or efficiency can be given.  
Made with Metropix C2025

