

## 15 Stock Lea Road, North Wootton PE30 3RP

£229,995

 2  1  1



**NO ONWARD CHAIN!** If you're searching for your first home, this stylish semi-detached house in the ever-popular village of North Wootton should be top of your list. Just a short stroll from local shops and the primary school, this well-proportioned two-bedroom property offers everything you need to step confidently onto the property ladder.



## Key Features

- Semi-Detached House
- Sought After Village
- Perfect First Home
- Garage and Off-road Parking
- Set Within a Cul-de-sac
- Two Double Bedrooms
- No Onward Chain
- Generous and Enclosed Rear Garden
- Gas Central Heating
- Close to Village Amenities - Shops and School

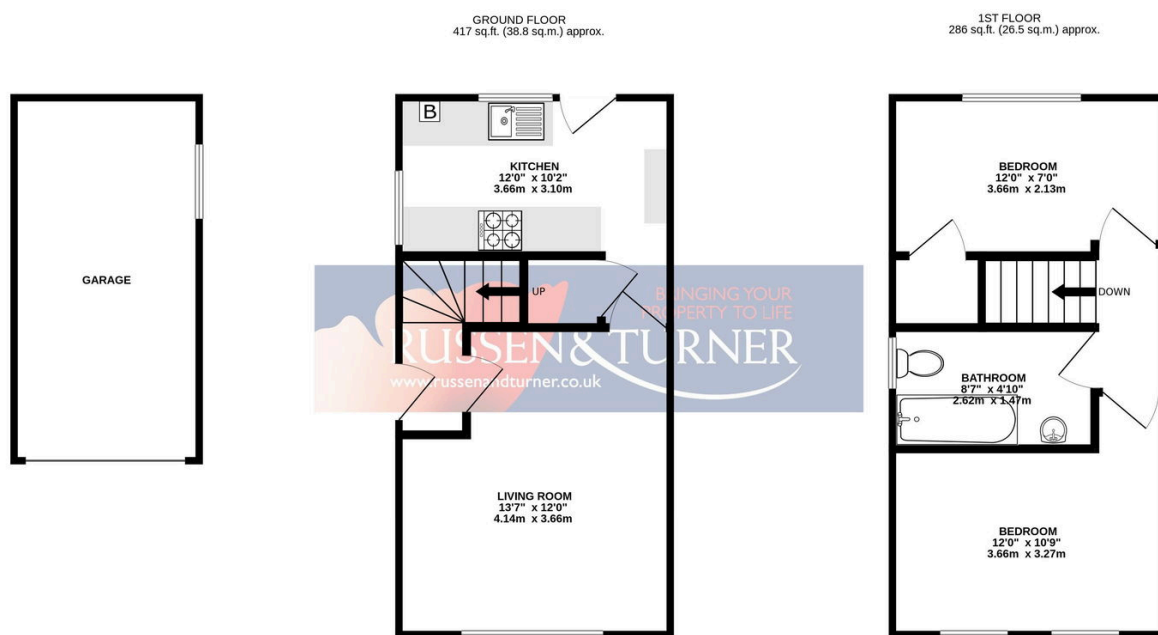

TOTAL FLOOR AREA : 703 sq.ft. (65.3 sq.m.) approx.

Whilst every attempt has been made to ensure the accuracy of the floorplan contained here, measurements of doors, windows, rooms and any other items are approximate and no responsibility is taken for any error, omission or mis-statement. This plan is for illustrative purposes only and should be used as such by any prospective purchaser. The services, systems and appliances shown have not been tested and no guarantee as to their operability or efficiency can be given.  
Made with Metropix ©2025