

3 Gregory Close, North Wootton, King's Lynn PE30 3SY

£335,000

 3  1  2



NO ONWARD CHAIN! If you've been dreaming of a home that offers space, comfort and a more relaxed pace of life, this could be the one. Perfectly positioned in a quiet cul-de-sac in the ever-popular village of North Wootton, this beautifully presented three-bedroom detached bungalow sits on a generous and private corner plot, the ideal setting for peaceful village living.

Key Features

- Detached Bungalow
- Private Rear Garden
- Sought After Location - Set within a close
- Gas Central Heating
- Potential to Make Your Own
- Three Bedrooms
- No Onward Chain
- Integral Garage
- Generous Accommodation
- Off-road Parking

GROUND FLOOR
1236 sq.ft. (114.9 sq.m.) approx.

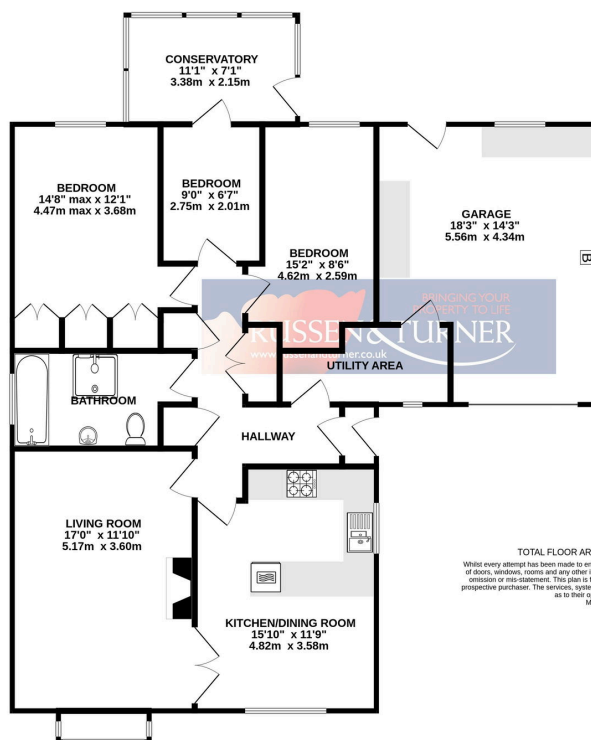

TOTAL FLOOR AREA: 1236 sq.ft. (114.9 sq.m.) approx.

Whilst every attempt has been made to ensure the accuracy of the floorplan contained here, measurements of doors, windows, rooms and any other items are approximate and no responsibility is taken for any error, omission or mis-statement. This plan is for illustrative purposes only and should be used as such by any prospective purchaser. The services, systems and appliances shown have not been tested and no guarantee as to their operability or efficiency can be given.
Made with Memphis 02/2025