

74 Charlock, King's Lynn PE30 3BN

£110,000

 2  1  1



NO ONWARDS CHAIN! Whether you're a first-time buyer looking for a home to grow into or somebody looking to downsize without the enclosed feel, this spacious ground floor flat ticks all the right boxes. Just a short journey to King's Lynn's town centre, it offers a fantastic mix of space, potential, and convenience, with the added plus of no onward chain, making your your move as easy as possible.

Key Features

- Ground floor flat
- 2 Double bedrooms
- Leasehold
- Gas central heating
- Generous accommodation
- No onward chain
- Council tax band - A
- Ideal first home or potential investment
- 21ft Lounge/Diner
- Utility room

GROUND FLOOR
742 sq.ft. (69.0 sq.m.) approx.

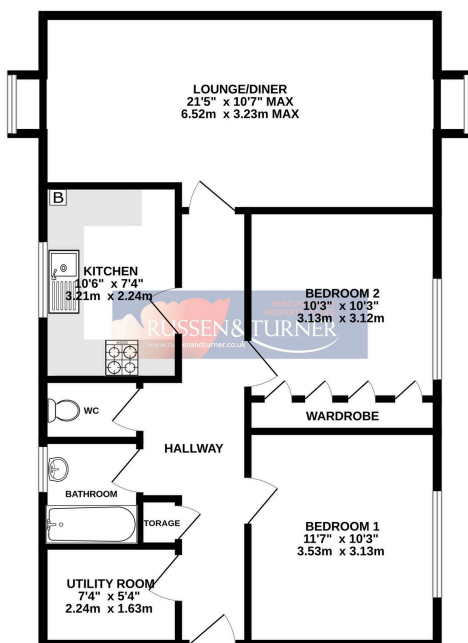

TOTAL FLOOR AREA: 742 sq.ft. (69.0 sq.m.) approx.

Whilst every attempt has been made to ensure the accuracy of the floorplan contained here, measurements of doors, windows, rooms and any other items are approximate and no responsibility is taken for any error, omission or misstatement. This plan is for illustrative purposes only and should be used as such by any prospective purchaser. The services, systems and appliances shown have not been tested and no guarantee as to their operability or efficiency can be given.
Made with letrotop ©2025