

8 Wisbech Road, King's Lynn PE30 5JN

£110,000

🛏 3 🚿 1 🚗 2



Investor Project – 3-Bed Terraced in South Lynn

An exciting opportunity for investors, this turn-of-the-century 3-bedroom terraced house in South Lynn, King's Lynn offers huge potential. Featuring 2 reception rooms, kitchen, ground floor bathroom, interlinked bedrooms and some original features, the property requires full renovation but already benefits from double glazing, front and rear gardens, and no onward chain. Ideal as a buy-to-let or resale project, it offers strong scope to add value and achieve excellent returns in a well-connected residential area with proven rental demand. Not suitable for first-time buyers, this is a prime investment opportunity.

Key Features

- Investor opportunity
- 2 Receptions
- Double glazed
- Popular location
- Outbuildings
- 3 (interlinked) bedrooms
- Requires refurbishment
- No chain
- Front & rear garden
- Proven rental demand area

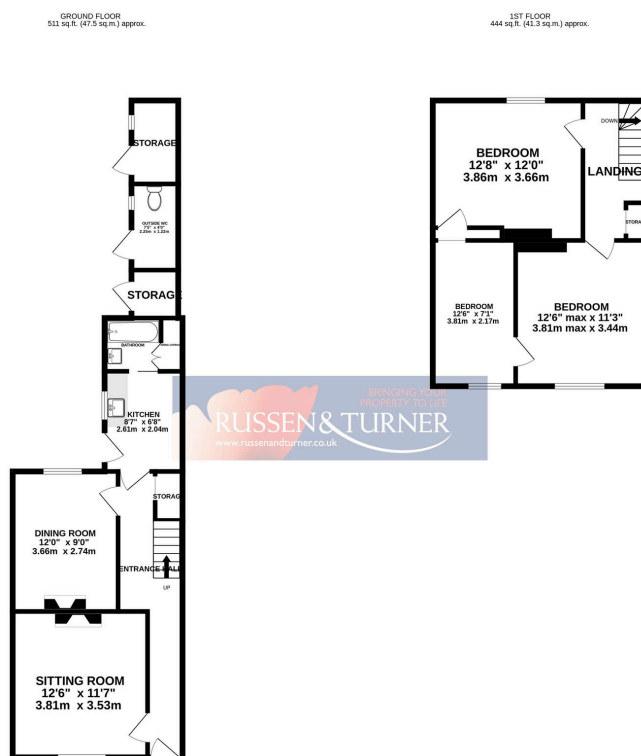

TOTAL FLOOR AREA: 955 sq.ft. (88.7 sq.m.) approx.
Whilst every attempt has been made to ensure the accuracy of the floorplan contained here, measurements of doors, windows, rooms and any other items are approximate and no responsibility is taken for any error, omission or misstatement. This plan is for illustrative purposes only and should be used as such by any prospective purchaser. The services, systems and appliances shown have not been tested and no guarantee as to their operability or efficiency can be given.
Made with Metropix 02025