

35 Chequers Road, King's Lynn, PE32 1AJ

£279,995

3 1 1



NO ONWARD CHAIN - Tucked away at the end of a private lane on the edge of the sought-after Norfolk village of Grimston, this deceptively spacious three-bedroom detached bungalow offers a rare opportunity to enjoy a quieter pace of life. Surrounded by attractive gardens and with versatile accommodation throughout, this home is perfect for those looking to downsize, retire in comfort, or simply escape the hustle and bustle of modern living.

Key Features

- Detached Bungalow
- Deceptively Spacious Gardens
- No Onward Chain
- Off-road Parking
- Newly Fitted Bathroom and Carpets
- Three Bedrooms
- Set at the bottom of a Private Lane
- Generous Living Room
- Hobby/Store Room
- Popular Rural Village

GROUND FLOOR 1100 sq.ft. (102.2 sq.m.) approx.

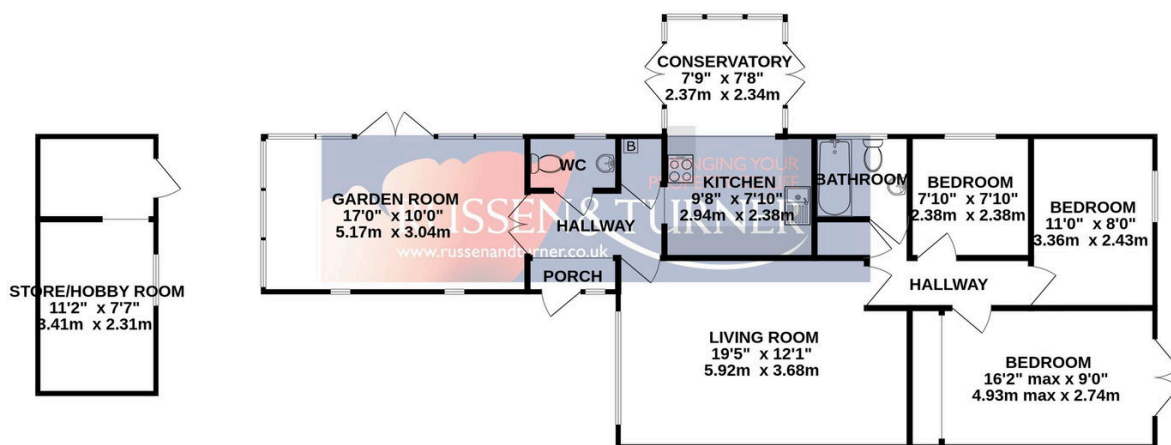

TOTAL FLOOR AREA : 1100 sq.ft. (102.2 sq.m.) approx.

Whilst every attempt has been made to ensure the accuracy of the floorplan contained here, measurements of doors, windows, rooms and any other items are approximate and no responsibility is taken for any error, omission or mis-statement. This plan is for illustrative purposes only and should be used as such by any prospective purchaser. The services, systems and appliances shown have not been tested and no guarantee as to their operability or efficiency can be given.
Made with Metropix ©2025