

48 Methuen Avenue, King's Lynn PE30 4BW

£189,995

 3  1  2



NO ONWARD CHAIN!! If you've been dreaming of your very first home, somewhere you can make your own, add your style, and grow into, this three-bedroom mid-terraced house just off the ever-popular Wootton Road could be exactly what you've been searching for.



Key Features

- Mid Terraced House
- Three Bedrooms
- Superb Location - Backing on to Gaywood River and Just off Wootton Road
- No Onward Chain
- Two Reception Rooms
- Stunning Rear Garden
- Garage
- Close to Local Amenities
- Council Tax Band - A
- Gas Central Heating

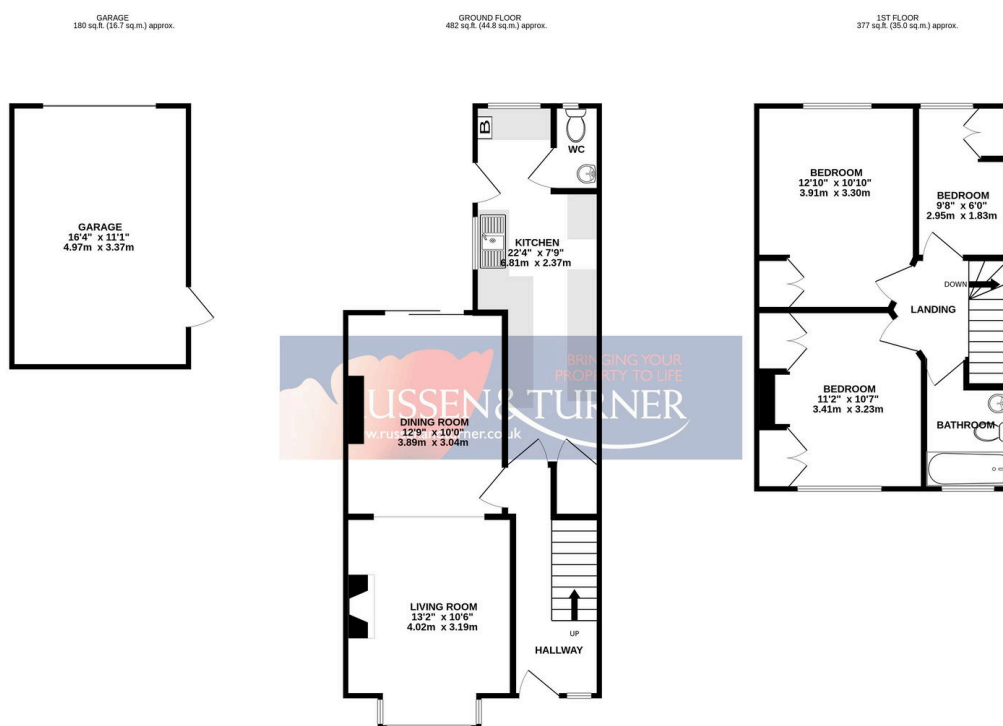

TOTAL FLOOR AREA : 1038 sq.ft. (96.5 sq.m.) approx.

Whilst every attempt has been made to ensure the accuracy of the floorplan contained here, measurements of doors, windows, rooms and any other items are approximate and no responsibility is taken for any error, omission or mis-statement. This plan is for illustrative purposes only and should be used as such by any prospective purchaser. The services, systems and appliances shown have not been tested and no guarantee as to their operability or efficiency can be given.
Made with Metropix ©2023