

22 Minnow Avenue, King's Lynn PE30 5FD

£279,995

 4  2  1



Set on the edge of town, this generously proportioned four double bedroom family home offers the perfect balance of space, comfort, and convenience. Thoughtfully arranged over three floors, the property combines bright, airy living with practical features every modern family needs, from allocated off-road parking and an enclosed rear garden to a versatile layout that adapts as your family grows.

Key Features

- Mid Terraced House
- Allocated Off-road Parking
- Well Presented
- Enclosed Rear Garden
- Ideal Family Home
- Four Superb Double Bedrooms
- Popular Location
- Main Bedroom with En-suite and Dressing Area
- Gas Central Heating
- Walking Distance to Town Centre

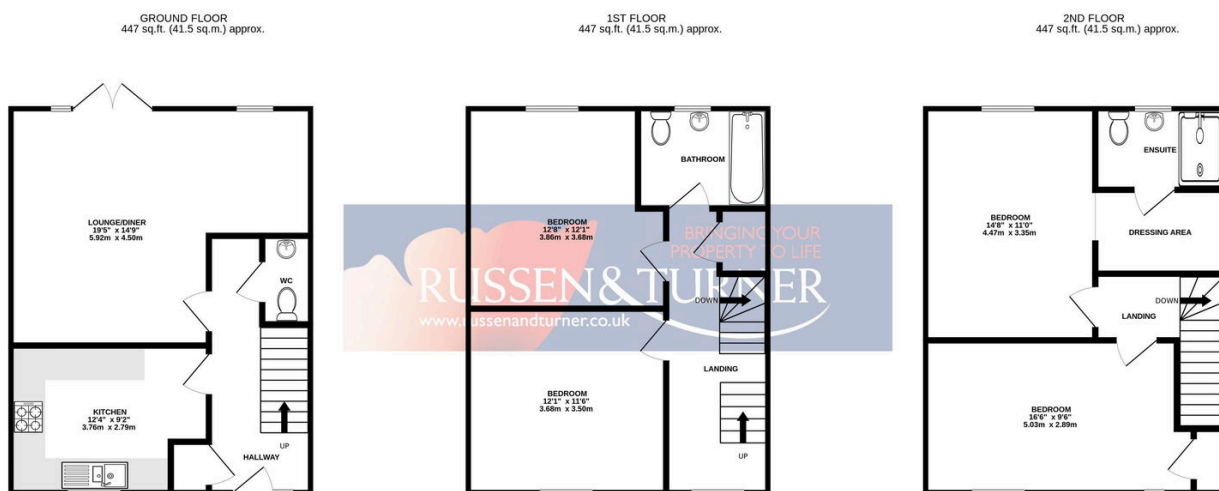

TOTAL FLOOR AREA: 1341 sq.ft. (124.5 sq.m.) approx.

Whilst every attempt has been made to ensure the accuracy of the floorplan contained here, measurements of doors, windows, rooms and any other items are approximate and no responsibility is taken for any error, omission or mis-statement. This plan is for illustrative purposes only and should be used as such by any prospective purchaser. The services, systems and appliances shown have not been tested and no guarantee as to their operability or efficiency can be given.
Made with Metropix ©2025