

58 Eastfields, King's Lynn PE30 4SF

£135,000

🛏 2 🚿 1 🛋 1



NO ONWARD CHAIN!! Tucked away in one of King's Lynn's most sought-after spots, just a stone's throw from the Queen Elizabeth Hospital, this charming two double bedroom end-of-terrace home is bursting with opportunity, whether you're taking your first step onto the property ladder or looking for your next smart investment.



Key Features

- End of Terrace House
- Close to Hospital
- No Onward Chain
- Generous Living/Dining Room
- Ideal First Home
- Two Double Bedrooms
- Low Maintenance Rear Garden
- Study/Dressing Room on First Floor
- Electric Heating
- Make this property your own

GROUND FLOOR
424 sq.ft. (39.4 sq.m.) approx.

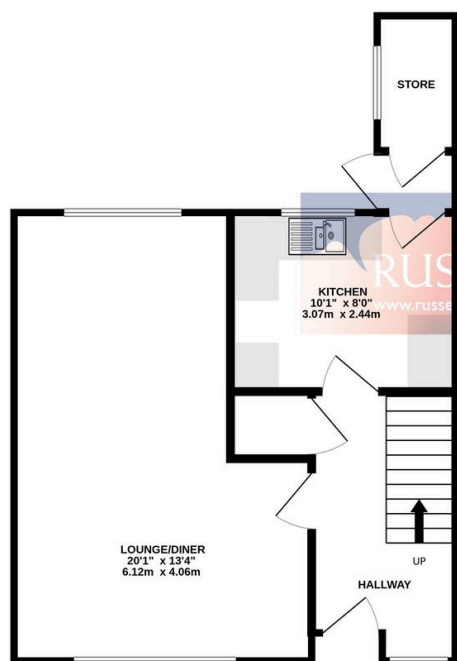

1ST FLOOR
397 sq.ft. (36.9 sq.m.) approx.

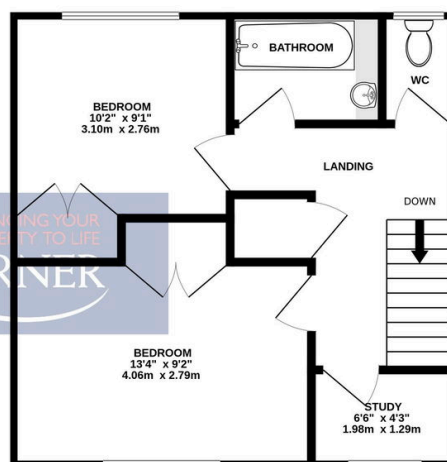

TOTAL FLOOR AREA : 821 sq.ft. (76.2 sq.m.) approx.

Whilst every attempt has been made to ensure the accuracy of the floorplan contained here, measurements of doors, windows, rooms and any other items are approximate and no responsibility is taken for any error, omission or mis-statement. This plan is for illustrative purposes only and should be used as such by any prospective purchaser. The services, systems and appliances shown have not been tested and no guarantee as to their operability or efficiency can be given.
Made with Metropix ©2025