

Plot 21 Howards Way, Gayton PE32 1WJ

£595,000

 4  2  2



Welcome to a thoughtfully designed collection of characterful homes in the heart of Gayton, a friendly Norfolk village surrounded by beautiful countryside. Built by a trusted local developer, each property offers a unique design, combining quality craftsmanship with modern, energy-efficient living. A limited number of fully serviced plots are also available, giving buyers the chance to work alongside the builder for a more bespoke finish. With spacious layouts, premium features, and a welcoming community feel, this is a rare opportunity to own a truly individual home in a special location.

NOTE: All Photos are example pictures taken of some of the completed homes to show the finish quality and some of the designs available.

Key Features

- Brand New Home
- High end finish
- Choice of design
- Large garage
- Local builder
- Executive design
- Desirable village
- Opportunity to work with builder
- Character design
- Call R&T to arrange a meeting with the builder

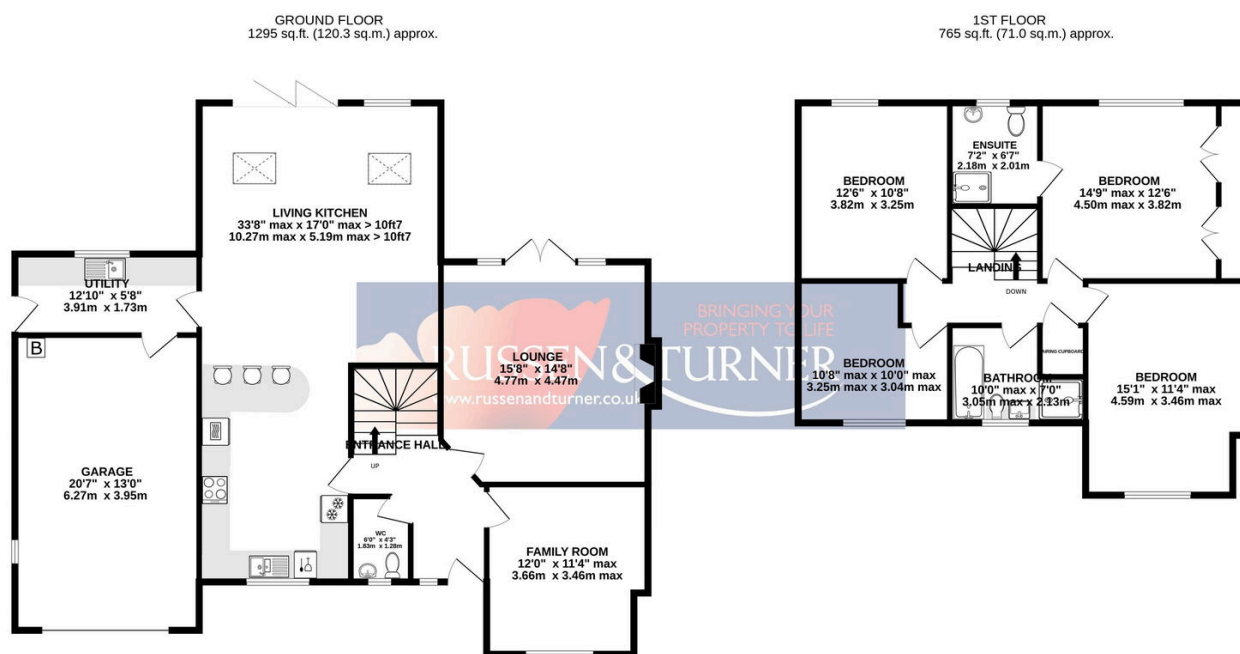

TOTAL FLOOR AREA : 2059 sq.ft. (191.3 sq.m.) approx.

Whilst every attempt has been made to ensure the accuracy of the floorplan contained here, measurements of doors, windows, rooms and any other items are approximate and no responsibility is taken for any error, omission or mis-statement. This plan is for illustrative purposes only and should be used as such by any prospective purchaser. The services, systems and appliances shown have not been tested and no guarantee as to their operability or efficiency can be given.

Made with Metropix ©2025