

## Hatherley Gardens, Barton Bendish

£289,995

 4  1  1



Welcome to this beautifully presented, generously proportioned detached bungalow, nestled in the idyllic and tranquil Norfolk village of Barton Bendish. This delightful home effortlessly combines spacious living with cozy charm, offering the perfect haven for families, retirees, or those simply seeking a peaceful countryside lifestyle.

## Key Features

- Detached Bungalow
- No Onward Chain
- Modern Kitchen
- Oil Fired Central Heating
- Generous Living Room with Woodburner
- Four Double Bedrooms
- Private Rear Garden
- Off-road Parking
- Set Within a Cul-de-sac
- Found within a Picturesque Norfolk Village

## GROUND FLOOR 1395 sq.ft. (129.6 sq.m.) approx.

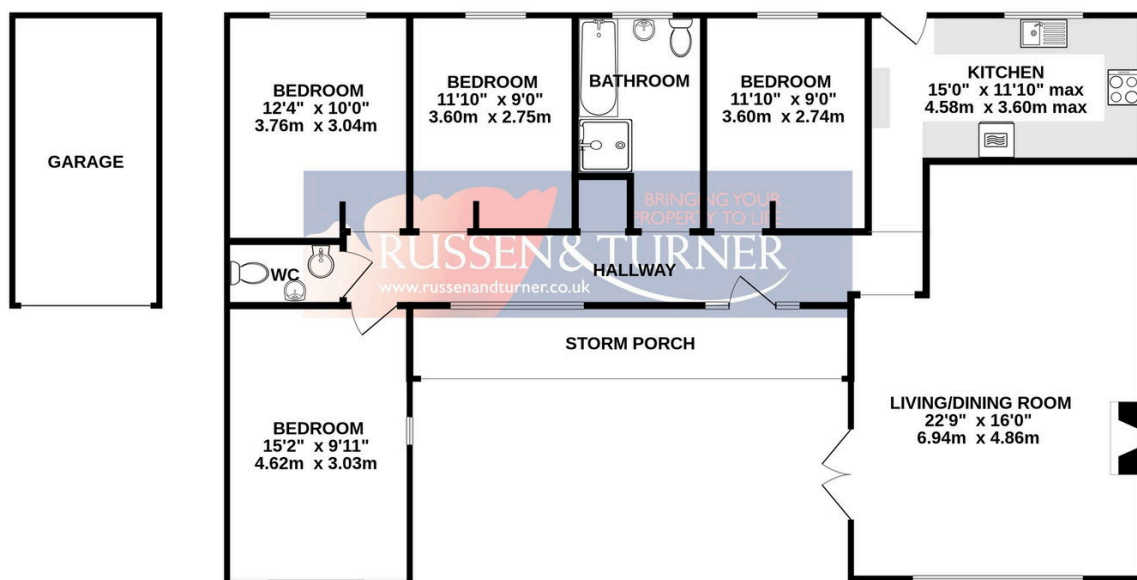

TOTAL FLOOR AREA : 1395 sq.ft. (129.6 sq.m.) approx.

Whilst every attempt has been made to ensure the accuracy of the floorplan contained here, measurements of doors, windows, rooms and any other items are approximate and no responsibility is taken for any error, omission or mis-statement. This plan is for illustrative purposes only and should be used as such by any prospective purchaser. The services, systems and appliances shown have not been tested and no guarantee as to their operability or efficiency can be given.  
Made with Metropix ©2025