

8 Jermyn Road, King's Lynn PE30 4AD

£350,000

 3  1  3



This extended bay-fronted gem in the Springwood catchment area boasts 3 reception rooms, a garden room, south-facing garden, 25ft garage, gardener's loo, and no onward chain—perfect for families and green-fingered dreamers alike!

Key Features

- Prime Location
- Period charm
- Generous, south facing garden
- Parking
- Extended property
- 3 bedroom
- Versatile living space
- Gardeners loo
- 25ft Garage
- No chain

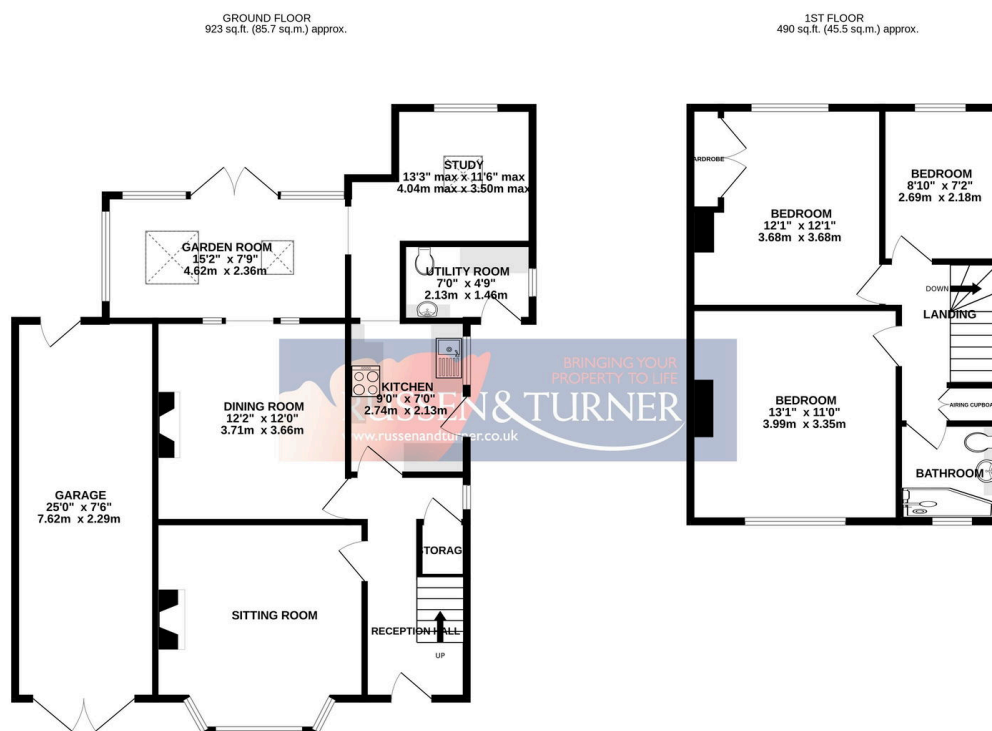

TOTAL FLOOR AREA: 1413 sq.ft. (131.3 sq.m.) approx.
Whilst every attempt has been made to ensure the accuracy of the floorplan contained here, measurements of doors, windows, rooms and any other items are approximate and no responsibility is taken for any error, omission or mis-statement. This plan is for illustrative purposes only and should be used as such by any prospective purchaser. The services, systems and appliances shown have not been tested and no guarantee as to their operability or efficiency can be given.
Made with Metropix ©2025

