

4 Savage Close, King's Lynn PE30 4BG

£105,000

🛏 1 🚗 1 🛋 1



Calling all First Time Buyers! Located close to the QE Hospital, this beautifully presented, first floor apartment could be your ideal 1st time home! Set toward the end of a cul-de-sac and with its own parking space the property has gas central heating and is double glazed throughout.

Key Features

- 1st Floor apartment
- 15ft Lounge
- Double glazed
- Contemporary design
- 1 mile from QE Hospital
- 1 Double bedroom
- Gas central heating
- Parking
- Close to amenities
- Turn key ready

GROUND FLOOR
463 sq.ft. (43.0 sq.m.) approx.

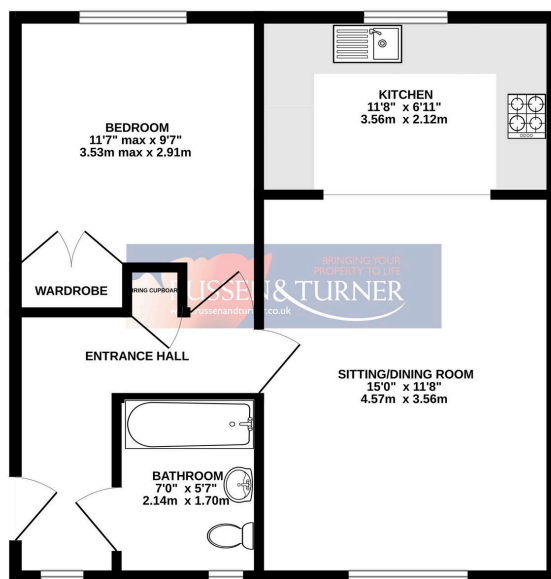

TOTAL FLOOR AREA - 463 sq.ft. (43.0 sq.m.) approx.

Whilst every attempt has been made to ensure the accuracy of the floorplan contained here, measurements of doors, windows, rooms and any other items are approximate and no responsibility is taken for any error, omission or mis-statement. This plan is for illustrative purposes only and should be used as such by any prospective purchaser. The services, systems and appliances shown have not been tested and no guarantee as to their operability or efficiency can be given.
Made with Metropix C2024