

## 37 Castle Rising Road, South Wootton

£430,000

 3  1  2



Found along one of the most sought after and highly desirable roads in King's Lynn and West Norfolk, this substantial, detached bungalow offers huge potential. On a fabulous plot measuring in at almost 1/3 of acre (STMS), this is a property where you can let your imagination run wild and turn it into the home of your dreams.

## Key Features

- Substantial Detached Bungalow
- Two Reception Rooms
- Huge Potential to Extend or Improve (STPP)
- Highly Desirable and Much Sought After Location
- Stunning Front and Rear Gardens
- Three Bedrooms
- Generous Plot - Just under 1/3 of an acre (STMS)
- No Onward Chain
- 36ft Garage plus Abundance of Parking
- Gas Central Heating

GROUND FLOOR  
1401 sq.ft. (130.1 sq.m.) approx.

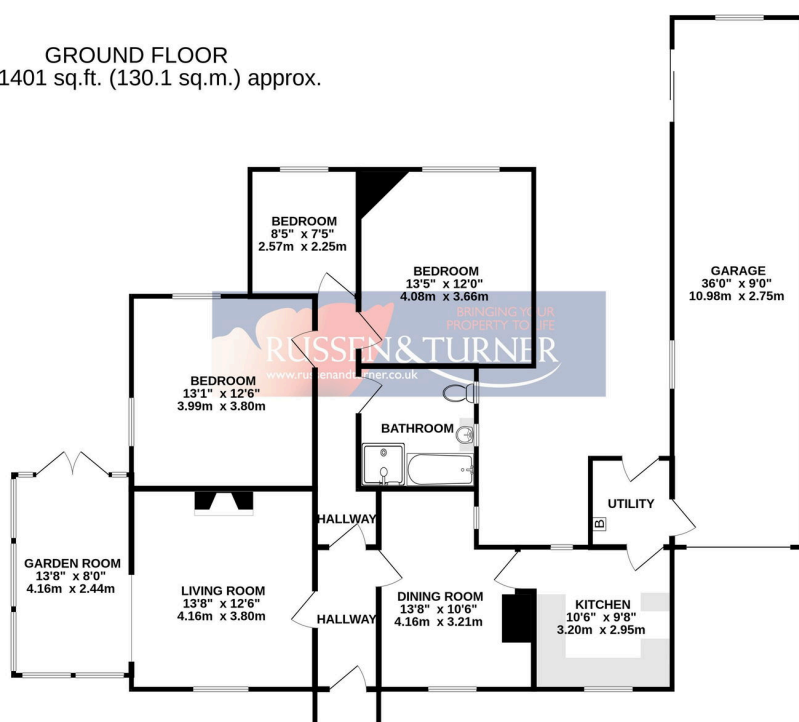

TOTAL FLOOR AREA: 1401 sq.ft. (130.1 sq.m.) approx.

Whilst every attempt has been made to ensure the accuracy of the floorplan contained here, measurements of doors, windows, rooms and any other items are approximate and no responsibility is taken for any error, omission or mis-statement. This plan is for illustrative purposes only and should be used as such by any prospective purchaser. The services, systems and appliances shown have not been tested and no guarantee as to their operability or efficiency can be given.  
Made with Metropix 02024